

Unity Knee™

Product Catalogue



Corin
Connected Orthopaedic Insight

Table of contents

Unity Knee™

System compatibility chart 3

Sizing chart 5

Implants

Femoral 6

Tibial inserts 8

Tibial Tray 17

Patella 18

Stems 19

Augment 20

Screws 22

Instrumentation

Monoblock 23

DPI 36

ASC 40

Additional instruments 47

Ordering information 48

Collaterals 49

Unity Knee™ Primary System Compatibility

Unity Knee™ Sizing guide

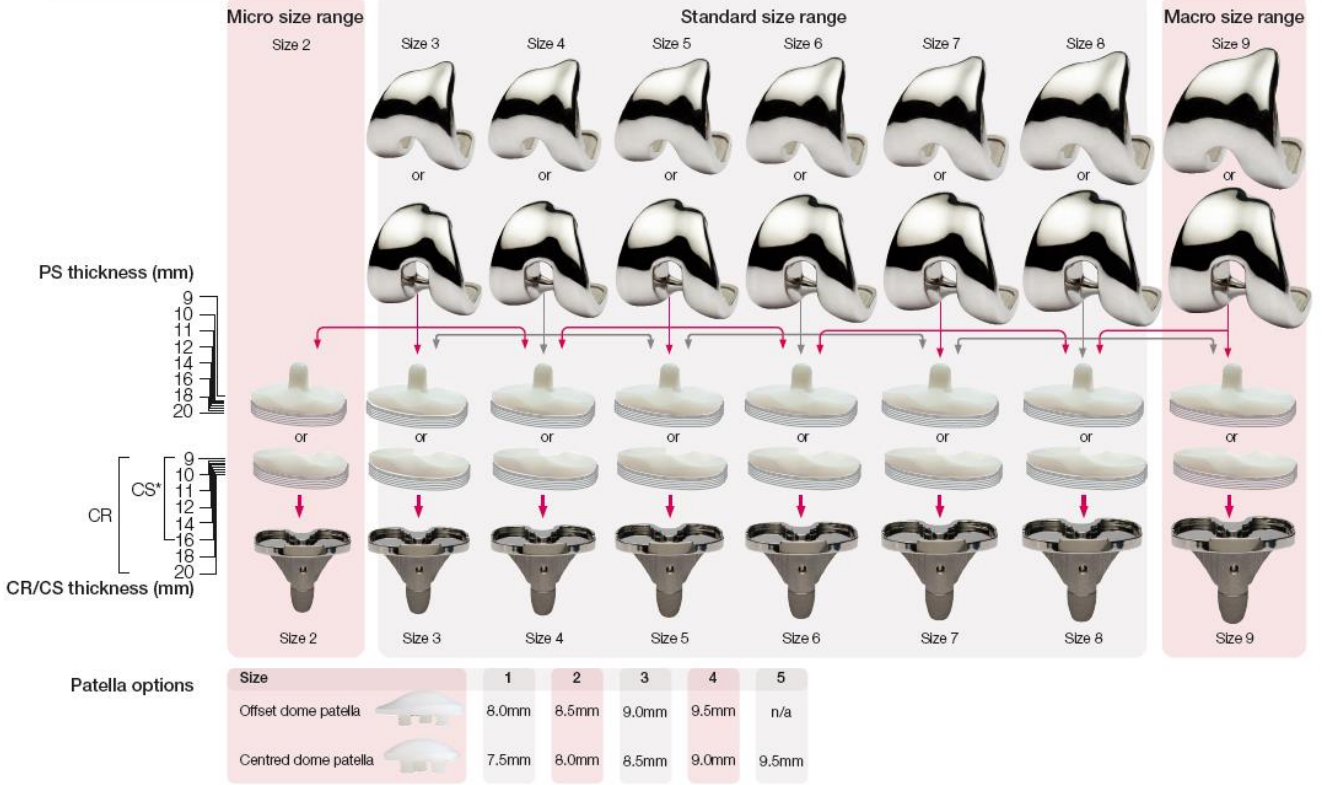

*CS insert must be used with CR femur.

Unity Knee™ DPI System Compatibility

Unity DPI Sizing guide

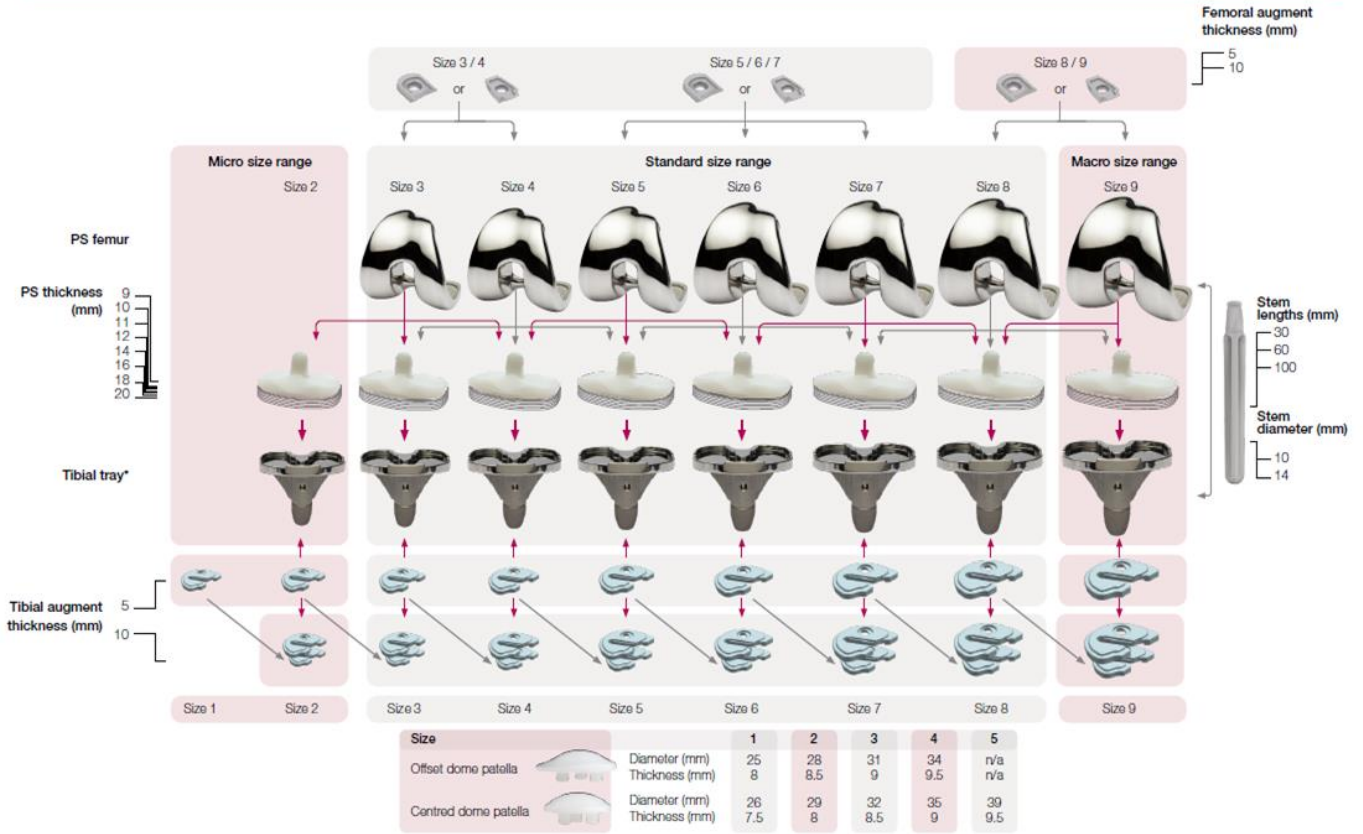

*Tibial tray is compatible with stem and tibial augments regardless of CR or PS insert variants

Unity Knee™ Sizing chart

Femoral component

Size	A/P (mm)	M/L (mm)
3	57.7	62
4	59	65
5	62.3	68
6	65.4	71
7	68.6	74
8	71.5	77.5
9	74.9	81

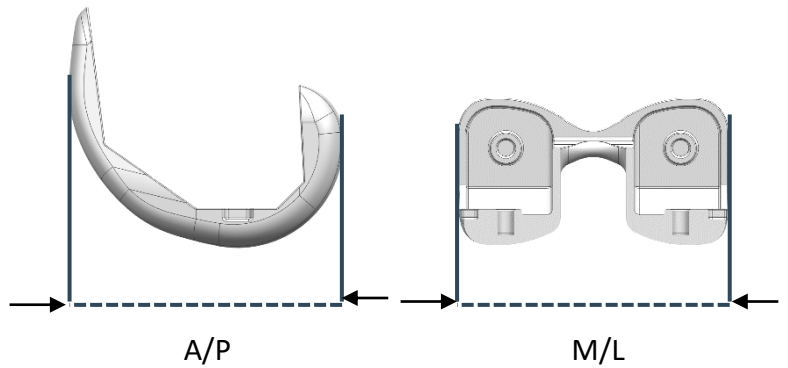

Tibial baseplate

Size	A/P (mm)	M/L (mm)
2	41	62
3	42.3	65
4	44.5	68
5	46.5	71
6	48.5	74
7	51	77.5
8	54.6	81
9	56.5	84.5

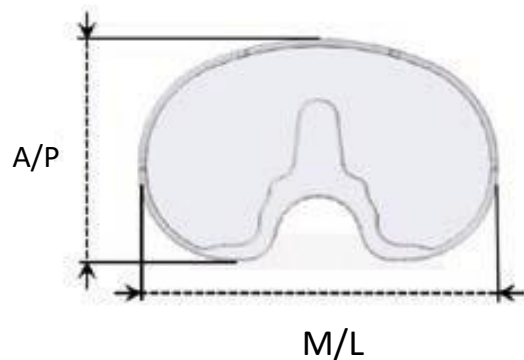

Unity Knee™ CR Femur Cemented



Unity Knee™ CR Femur - Cemented

LEFT

CODES	DESCRIPTION
112.001.06	Unity Knee CR Femur, Cemented, Size 3
112.001.08	Unity Knee CR Femur, Cemented, Size 4
112.001.10	Unity Knee CR Femur, Cemented, Size 5
112.001.12	Unity Knee CR Femur, Cemented, Size 6
112.001.14	Unity Knee CR Femur, Cemented, Size 7
112.001.16	Unity Knee CR Femur, Cemented, Size 8
112.001.18	Unity Knee CR Femur, Cemented, Size 9

RIGHT

CODES	DESCRIPTION
112.001.26	Unity Knee CR Femur, Cemented, Size 3
112.001.28	Unity Knee CR Femur, Cemented, Size 4
112.001.30	Unity Knee CR Femur, Cemented, Size 5
112.001.32	Unity Knee CR Femur, Cemented, Size 6
112.001.34	Unity Knee CR Femur, Cemented, Size 7
112.001.36	Unity Knee CR Femur, Cemented, Size 8
112.001.38	Unity Knee CR Femur, Cemented, Size 9

Unity Knee™ PS Femur Cemented



Unity Knee™ PS Femur - Cemented

LEFT

CODES	DESCRIPTION
112.001.66	Unity Knee PS Femur, Cemented, Size 3
112.001.68	Unity Knee PS Femur, Cemented, Size 4
112.001.70	Unity Knee PS Femur, Cemented, Size 5
112.001.72	Unity Knee PS Femur, Cemented, Size 6
112.001.74	Unity Knee PS Femur, Cemented, Size 7
112.001.76	Unity Knee PS Femur, Cemented, Size 8
112.001.78	Unity Knee PS Femur, Cemented, Size 9

RIGHT

CODES	DESCRIPTION
112.001.46	Unity Knee PS Femur, Cemented, Size 3
112.001.48	Unity Knee PS Femur, Cemented, Size 4
112.001.50	Unity Knee PS Femur, Cemented, Size 5
112.001.52	Unity Knee PS Femur, Cemented, Size 6
112.001.54	Unity Knee PS Femur, Cemented, Size 7
112.001.56	Unity Knee PS Femur, Cemented, Size 8
112.001.58	Unity Knee PS Femur, Cemented, Size 9

Unity Knee™ CR Tibial Insert



Unity Knee™ CR Tibial Inserts

SIZE 2

CODES	DESCRIPTION
112.014.22	Unity Knee CR Tibial Insert 9mm
112.014.23	Unity Knee CR Tibial Insert 10mm
112.014.24	Unity Knee CR Tibial Insert 11mm
112.014.25	Unity Knee CR Tibial Insert 12mm
112.014.26	Unity Knee CR Tibial Insert 14mm
112.014.27	Unity Knee CR Tibial Insert 16mm
112.014.28	Unity Knee CR Tibial Insert 18mm
112.014.29	Unity Knee CR Tibial Insert 20mm

SIZE 3

CODES	DESCRIPTION
112.014.42	Unity Knee CR Tibial Insert 9mm
112.014.43	Unity Knee CR Tibial Insert 10mm
112.014.44	Unity Knee CR Tibial Insert 11mm
112.014.45	Unity Knee CR Tibial Insert 12mm
112.014.46	Unity Knee CR Tibial Insert 14mm
112.014.47	Unity Knee CR Tibial Insert 16mm
112.014.48	Unity Knee CR Tibial Insert 18mm
112.014.49	Unity Knee CR Tibial Insert 20mm

SIZE 4

CODES	DESCRIPTION
112.014.62	Unity Knee CR Tibial Insert 9mm
112.014.63	Unity Knee CR Tibial Insert 10mm
112.014.64	Unity Knee CR Tibial Insert 11mm
112.014.65	Unity Knee CR Tibial Insert 12mm
112.014.66	Unity Knee CR Tibial Insert 14mm
112.014.67	Unity Knee CR Tibial Insert 16mm
112.014.68	Unity Knee CR Tibial Insert 18mm
112.014.69	Unity Knee CR Tibial Insert 20mm

Unity Knee™ CR Tibial Insert (contd.)



Unity Knee™ CR Tibial Inserts

SIZE 5

CODES	DESCRIPTION
112.014.82	Unity Knee CR Tibial Insert 9mm
112.014.83	Unity Knee CR Tibial Insert 10mm
112.014.84	Unity Knee CR Tibial Insert 11mm
112.014.85	Unity Knee CR Tibial Insert 12mm
112.014.86	Unity Knee CR Tibial Insert 14mm
112.014.87	Unity Knee CR Tibial Insert 16mm
112.014.88	Unity Knee CR Tibial Insert 18mm
112.014.89	Unity Knee CR Tibial Insert 20mm

SIZE 6

CODES	DESCRIPTION
112.015.02	Unity Knee CR Tibial Insert 9mm
112.015.03	Unity Knee CR Tibial Insert 10mm
112.015.04	Unity Knee CR Tibial Insert 11mm
112.015.05	Unity Knee CR Tibial Insert 12mm
112.015.06	Unity Knee CR Tibial Insert 14mm
112.015.07	Unity Knee CR Tibial Insert 16mm
112.015.08	Unity Knee CR Tibial Insert 18mm
112.015.09	Unity Knee CR Tibial Insert 20mm

SIZE 7

CODES	DESCRIPTION
112.015.22	Unity Knee CR Tibial Insert 9mm
112.015.23	Unity Knee CR Tibial Insert 10mm
112.015.24	Unity Knee CR Tibial Insert 11mm
112.014.65	Unity Knee CR Tibial Insert 12mm
112.014.66	Unity Knee CR Tibial Insert 14mm
112.014.67	Unity Knee CR Tibial Insert 16mm
112.014.68	Unity Knee CR Tibial Insert 18mm
112.014.69	Unity Knee CR Tibial Insert 20mm

Unity Knee™ CR Tibial Insert (contd.)



Unity Knee™ CR Tibial Inserts

SIZE 8

CODES	DESCRIPTION
112.015.42	Unity Knee CR Tibial Insert 9mm
112.015.43	Unity Knee CR Tibial Insert 10mm
112.015.44	Unity Knee CR Tibial Insert 11mm
112.015.45	Unity Knee CR Tibial Insert 12mm
112.015.46	Unity Knee CR Tibial Insert 14mm
112.015.47	Unity Knee CR Tibial Insert 16mm
112.015.48	Unity Knee CR Tibial Insert 18mm
112.015.49	Unity Knee CR Tibial Insert 20mm

SIZE 9

CODES	DESCRIPTION
112.015.62	Unity Knee CR Tibial Insert 9mm
112.015.63	Unity Knee CR Tibial Insert 10mm
112.015.64	Unity Knee CR Tibial Insert 11mm
112.015.65	Unity Knee CR Tibial Insert 12mm
112.015.66	Unity Knee CR Tibial Insert 14mm
112.015.67	Unity Knee CR Tibial Insert 16mm
112.015.68	Unity Knee CR Tibial Insert 18mm
112.015.69	Unity Knee CR Tibial Insert 20mm

Unity Knee™ CS Tibial Insert

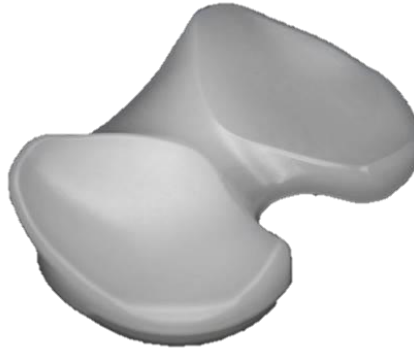

Unity Knee™ CS Tibial Inserts

SIZE 2

CODES	DESCRIPTION
1125122	Unity Knee CS Tibial Insert 9mm
1125123	Unity Knee CS Tibial Insert 10mm
1125124	Unity Knee CS Tibial Insert 11mm
1125125	Unity Knee CS Tibial Insert 12mm
1125126	Unity Knee CS Tibial Insert 14mm
1125127	Unity Knee CS Tibial Insert 16mm

SIZE 3

CODES	DESCRIPTION
1125142	Unity Knee CS Tibial Insert 9mm
1125143	Unity Knee CS Tibial Insert 10mm
1125144	Unity Knee CS Tibial Insert 11mm
1125145	Unity Knee CS Tibial Insert 12mm
1125146	Unity Knee CS Tibial Insert 14mm
1125147	Unity Knee CS Tibial Insert 16mm

SIZE 4

CODES	DESCRIPTION
1125162	Unity Knee CS Tibial Insert 9mm
1125163	Unity Knee CS Tibial Insert 10mm
1125164	Unity Knee CS Tibial Insert 11mm
1125165	Unity Knee CS Tibial Insert 12mm
1125166	Unity Knee CS Tibial Insert 14mm
1125167	Unity Knee CS Tibial Insert 16mm

Unity Knee™ CS Tibial Insert (contd.)

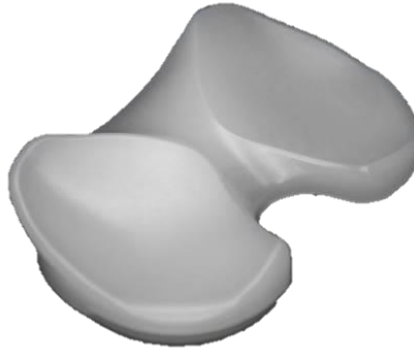

Unity Knee™ CS Tibial Inserts

SIZE 5

CODES	DESCRIPTION
1125182	Unity Knee CS Tibial Insert 9mm
1125183	Unity Knee CS Tibial Insert 10mm
1125184	Unity Knee CS Tibial Insert 11mm
1125185	Unity Knee CS Tibial Insert 12mm
1125186	Unity Knee CS Tibial Insert 14mm
1125187	Unity Knee CS Tibial Insert 16mm

SIZE 6

CODES	DESCRIPTION
1125202	Unity Knee CS Tibial Insert 9mm
1125203	Unity Knee CS Tibial Insert 10mm
1125204	Unity Knee CS Tibial Insert 11mm
1125205	Unity Knee CS Tibial Insert 12mm
1125206	Unity Knee CS Tibial Insert 14mm
1125207	Unity Knee CS Tibial Insert 16mm

SIZE 7

CODES	DESCRIPTION
1125222	Unity Knee CS Tibial Insert 9mm
1125223	Unity Knee CS Tibial Insert 10mm
1125224	Unity Knee CS Tibial Insert 11mm
1125225	Unity Knee CS Tibial Insert 12mm
1125226	Unity Knee CS Tibial Insert 14mm
1125227	Unity Knee CS Tibial Insert 16mm

Unity Knee™ CS Tibial Insert (contd.)

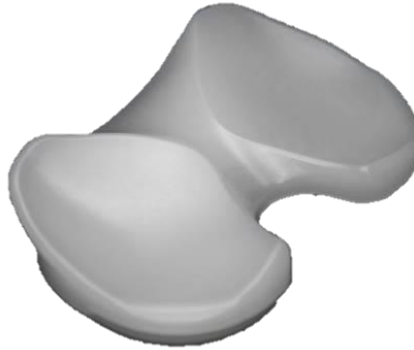

Unity Knee™ CS Tibial Inserts

SIZE 8

CODES	DESCRIPTION
1125242	Unity Knee CS Tibial Insert 9mm
1125243	Unity Knee CS Tibial Insert 10mm
1125244	Unity Knee CS Tibial Insert 11mm
1125245	Unity Knee CS Tibial Insert 12mm
1125246	Unity Knee CS Tibial Insert 14mm
1125247	Unity Knee CS Tibial Insert 16mm

SIZE 9

CODES	DESCRIPTION
1125262	Unity Knee CS Tibial Insert 9mm
1125263	Unity Knee CS Tibial Insert 10mm
1125264	Unity Knee CS Tibial Insert 11mm
1125265	Unity Knee CS Tibial Insert 12mm
1125266	Unity Knee CS Tibial Insert 14mm
1125267	Unity Knee CS Tibial Insert 16mm

Unity Knee™ PS Tibial Insert



Unity Knee™ PS Tibial Inserts

SIZE 2

CODES	DESCRIPTION
112.016.22	Unity Knee PS Tibial Insert 9mm
112.016.23	Unity Knee PS Tibial Insert 10mm
112.016.24	Unity Knee PS Tibial Insert 11mm
112.016.25	Unity Knee PS Tibial Insert 12mm
112.016.26	Unity Knee PS Tibial Insert 14mm
112.016.27	Unity Knee PS Tibial Insert 16mm
112.016.28	Unity Knee PS Tibial Insert 18mm
112.016.29	Unity Knee PS Tibial Insert 20mm

SIZE 3

CODES	DESCRIPTION
112.016.42	Unity Knee PS Tibial Insert 9mm
112.016.43	Unity Knee PS Tibial Insert 10mm
112.016.44	Unity Knee PS Tibial Insert 11mm
112.016.45	Unity Knee PS Tibial Insert 12mm
112.016.46	Unity Knee PS Tibial Insert 14mm
112.016.47	Unity Knee PS Tibial Insert 16mm
112.016.48	Unity Knee PS Tibial Insert 18mm
112.016.49	Unity Knee PS Tibial Insert 20mm

SIZE 4

CODES	DESCRIPTION
112.016.62	Unity Knee PS Tibial Insert 9mm
112.016.63	Unity Knee PS Tibial Insert 10mm
112.016.64	Unity Knee PS Tibial Insert 11mm
112.016.65	Unity Knee PS Tibial Insert 12mm
112.016.66	Unity Knee PS Tibial Insert 14mm
112.016.67	Unity Knee PS Tibial Insert 16mm
112.016.68	Unity Knee PS Tibial Insert 18mm
112.016.69	Unity Knee PS Tibial Insert 20mm

Unity Knee™ PS Tibial Insert (contd.)



Unity Knee™ PS Tibial Inserts

SIZE 5

CODES	DESCRIPTION
112.016.82	Unity Knee PS Tibial Insert 9mm
112.016.83	Unity Knee PS Tibial Insert 10mm
112.016.84	Unity Knee PS Tibial Insert 11mm
112.016.85	Unity Knee PS Tibial Insert 12mm
112.016.86	Unity Knee PS Tibial Insert 14mm
112.016.87	Unity Knee PS Tibial Insert 16mm
112.016.88	Unity Knee PS Tibial Insert 18mm
112.016.89	Unity Knee PS Tibial Insert 20mm

SIZE 6

CODES	DESCRIPTION
112.017.02	Unity Knee PS Tibial Insert 9mm
112.017.03	Unity Knee PS Tibial Insert 10mm
112.017.04	Unity Knee PS Tibial Insert 11mm
112.017.05	Unity Knee PS Tibial Insert 12mm
112.017.06	Unity Knee PS Tibial Insert 14mm
112.017.07	Unity Knee PS Tibial Insert 16mm
112.017.08	Unity Knee PS Tibial Insert 18mm
112.017.09	Unity Knee PS Tibial Insert 20mm

SIZE 7

CODES	DESCRIPTION
112.017.02	Unity Knee PS Tibial Insert 9mm
112.017.03	Unity Knee PS Tibial Insert 10mm
112.017.04	Unity Knee PS Tibial Insert 11mm
112.017.05	Unity Knee PS Tibial Insert 12mm
112.017.06	Unity Knee PS Tibial Insert 14mm
112.017.07	Unity Knee PS Tibial Insert 16mm
112.017.08	Unity Knee PS Tibial Insert 18mm
112.017.09	Unity Knee PS Tibial Insert 20mm

Unity Knee™ PS Tibial Insert (contd.)



Unity Knee™ PS Tibial Inserts

SIZE 8

CODES	DESCRIPTION
112.017.22	Unity Knee PS Tibial Insert 9mm
112.017.23	Unity Knee PS Tibial Insert 10mm
112.017.24	Unity Knee PS Tibial Insert 11mm
112.017.25	Unity Knee PS Tibial Insert 12mm
112.017.26	Unity Knee PS Tibial Insert 14mm
112.017.27	Unity Knee PS Tibial Insert 16mm
112.017.28	Unity Knee PS Tibial Insert 18mm
112.017.29	Unity Knee PS Tibial Insert 20mm

SIZE 9

CODES	DESCRIPTION
112.017.62	Unity Knee PS Tibial Insert 9mm
112.017.63	Unity Knee PS Tibial Insert 10mm
112.017.64	Unity Knee PS Tibial Insert 11mm
112.017.65	Unity Knee PS Tibial Insert 12mm
112.017.66	Unity Knee PS Tibial Insert 14mm
112.017.67	Unity Knee PS Tibial Insert 16mm
112.017.68	Unity Knee PS Tibial Insert 18mm
112.017.69	Unity Knee PS Tibial Insert 20mm

Unity Knee™ Primary Tibia Baseplate - Cemented



Unity Knee™ Primary Tibia Baseplate - Cemented

CODES	DESCRIPTION
112.040.04	Unity Knee Primary Tibia Baseplate, Cemented , Size 2
112.040.06	Unity Knee Primary Tibia Baseplate, Cemented , Size 3
112.040.08	Unity Knee Primary Tibia Baseplate, Cemented , Size 4
112.040.10	Unity Knee Primary Tibia Baseplate, Cemented , Size 5
112.040.12	Unity Knee Primary Tibia Baseplate, Cemented , Size 6
112.040.14	Unity Knee Primary Tibia Baseplate, Cemented , Size 7
112.040.16	Unity Knee Primary Tibia Baseplate, Cemented , Size 8
112.040.18	Unity Knee Primary Tibia Baseplate, Cemented , Size 9

Unity Knee™ Patella



Unity Knee™ Patella

Dome

CODES	DESCRIPTION
112.018.02	Unity Knee Dome Patella Size 1
112.018.04	Unity Knee Dome Patella Size 2
112.018.06	Unity Knee Dome Patella Size 3
112.018.08	Unity Knee Dome Patella Size 4
112.018.10	Unity Knee Dome Patella Size 5

Offset Dome

CODES	DESCRIPTION
112.018.42	Unity Knee Offset Dome Patella Size 1
112.018.46	Unity Knee Offset Dome Patella Size 2
112.018.52	Unity Knee Offset Dome Patella Size 3
112.018.56	Unity Knee Offset Dome Patella Size 4

Unity Knee™ Stem Extension



Unity Knee™ Stem - Cemented

CODES	DESCRIPTION
112.060.42	Unity Knee™ stem extension - 10mm Diameter x 30mm length
112.060.44	Unity Knee™ stem extension - 14mm Diameter x 30mm length
112.060.02	Unity Knee™ stem extension - 10mm Diameter x 60mm length
112.060.04	Unity Knee™ stem extension - 14mm Diameter x 60mm length
112.060.22	Unity Knee™ stem extension - 10mm Diameter x 100mm length
112.060.24	Unity Knee™ stem extension - 14mm Diameter x 100mm length

Unity Knee™ Tibial Augment



Unity Knee™ Tibial Augment - Cemented

Right Medial (RM)/ Left Lateral (LL)

CODES	DESCRIPTION
1123202	Unity Knee Tibial Augment, Size 1, Cemented
1123204	Unity Knee Tibial Augment, Size 2, Cemented
1123206	Unity Knee Tibial Augment, Size 3, Cemented
1123208	Unity Knee Tibial Augment, Size 4, Cemented
1123210	Unity Knee Tibial Augment, Size 5, Cemented
1123212	Unity Knee Tibial Augment, Size 6, Cemented
1123214	Unity Knee Tibial Augment, Size 7, Cemented
1123216	Unity Knee Tibial Augment, Size 8, Cemented
1123218	Unity Knee Tibial Augment, Size 9, Cemented

Right Lateral (RL)/ Left Medial (LM)

CODES	DESCRIPTION
1123222	Unity Knee Tibial Augment, Size 1, Cemented
1123224	Unity Knee Tibial Augment, Size 2, Cemented
1123226	Unity Knee Tibial Augment, Size 3, Cemented
1123228	Unity Knee Tibial Augment, Size 4, Cemented
1123230	Unity Knee Tibial Augment, Size 5, Cemented
1123232	Unity Knee Tibial Augment, Size 6, Cemented
1123234	Unity Knee Tibial Augment, Size 7, Cemented
1123236	Unity Knee Tibial Augment, Size 8, Cemented
1123238	Unity Knee Tibial Augment, Size 9, Cemented

Unity Knee™ Femoral Augment



Unity Knee™ Femoral Augment - Cemented

Distal Femoral Augment

CODES	DESCRIPTION
1122306	Unity Knee Femoral Augment, Cemented, Size 3/4 x thickness 5mm
1122310	Unity Knee Femoral Augment, Cemented, Size 5/6/7 x thickness 5mm
1122316	Unity Knee Femoral Augment, Cemented, Size 8/9 x thickness 5mm
1122346	Unity Knee Femoral Augment, Cemented, Size 3/4 x thickness 10mm
1122350	Unity Knee Femoral Augment, Cemented, Size 5/6/7 x thickness 10mm
1122356	Unity Knee Femoral Augment, Cemented, Size 8/9 x thickness 10mm

Posterior Femoral Augment

CODES	DESCRIPTION
1122326	Unity Knee Femoral Augment, Cemented, Size 3/4 x thickness 5mm
1122330	Unity Knee Femoral Augment, Cemented, Size 5/6/7 x thickness 5mm
1122336	Unity Knee Femoral Augment, Cemented, Size 8/9 x thickness 5mm
1122366	Unity Knee Femoral Augment, Cemented, Size 3/4 x thickness 10mm
1122370	Unity Knee Femoral Augment, Cemented, Size 5/6/7 x thickness 10mm
1122376	Unity Knee Femoral Augment, Cemented, Size 8/9 x thickness 10mm

Unity Knee™ Replacement screw

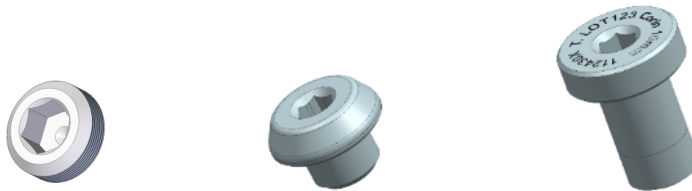

Replacement screw

Stem and Augment screw

CODES	DESCRIPTION
112.054.92	Unity Knee Stem Grub Screw (pack of 5)
1122301	Unity Knee 5mm Augment screw (individual)
1124302	Unity Knee 10mm Augment screw (individual)

Optional

1122305	Unity Knee 5mm Augment screw (pack of 5)
1124306	Unity Knee 10mm Augment screw (pack of 5)

Unity Knee™ Tibial preparation tray

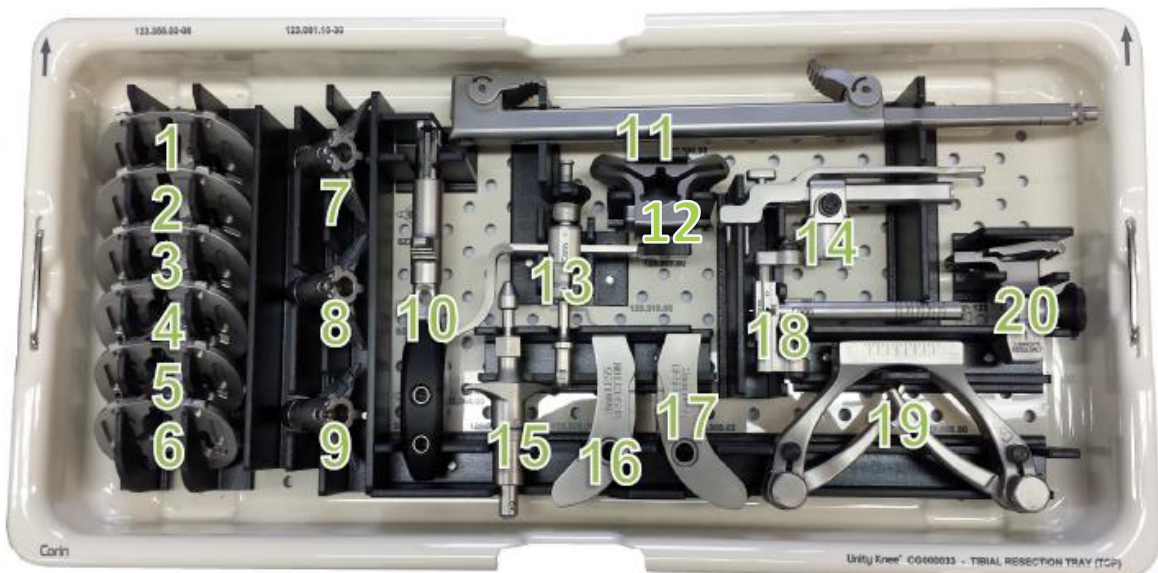

Ref#	Instrument	Codes
	Upper tray	CG000033
1	Tibial template - trial size 3	123.355.03
2	Tibial template - trial size 4	123.355.04
3	Tibial template - trial size 5	123.355.05
4	Tibial template - trial size 6	123.355.06
5	Tibial template - trial size 7	123.355.07
6	Tibial template - trial size 8	123.355.08
7	SIZE 1-3 Keel punch	123.061.10
8	SIZE 4-6 Keel punch	123.061.20
9	SIZE 7-9 Keel punch	123.061.30
10	Tibial template handle assembly	123.364.00
11	EM Tower with macro adjustment	123.308.00
12	Keel punch guide	123.357.00
13	Tibial stylus	123.310.00
14	EM Tibial spike	123.309.00
15	Keel punch modular release	123.063.00
16	Tibial cut block left	123.305.01
17	Tibial cut block right	123.305.02
18	EM tibial AP/ML guide	123.008.60
19	EM tibia - ankle clamp assy	123.008.50
20	Micro adjuster	123.308.28

Unity Knee™ Femoral preparation tray

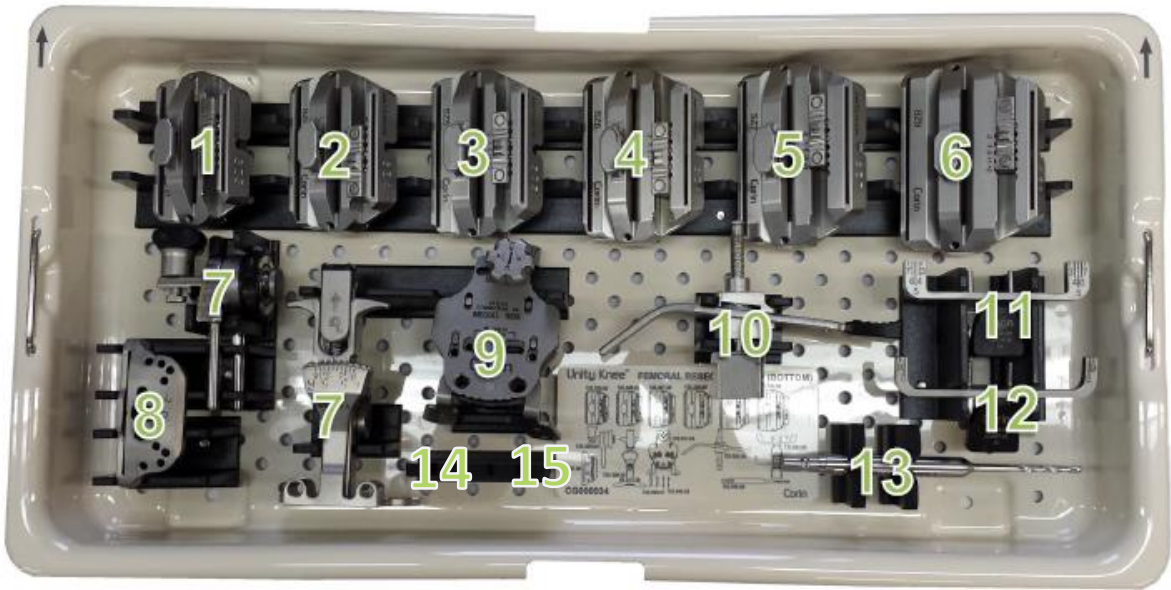

Ref#	Instrument	Codes
	Lower tray	CG000034
1	4:1 cutting block size 3	123.525.00
2	4:1 cutting block size 4	123.526.00
3	4:1 cutting block size 5	123.527.00
4	4:1 cutting block size 6	123.528.00
5	4:1 cutting block size 7	123.529.00
6	4:1 cutting block size 8	123.530.00
7	Distal IM femoral alignment jig	123.306.00
8	Distal femoral cutting block	123.007.00
9	Femoral sizer	123.301.00
10	Femoral sizer stylus	123.302.00
11	Femoral sizer ML width checker size 3-7	123.003.05
12	Femoral sizer ML width checker size 8-9	123.003.08
	A/O – 4:1 cutting block drill	A123.059.00
13	Hudson – 4:1 cutting block drill	H123.059.00
	Hall zimmer – 4:1 cutting block drill	123.059.00
14	Spacer shim 1mm	123.090.01
15	Spacer shim 2mm	123.090.02

Unity Knee™ General Instruments

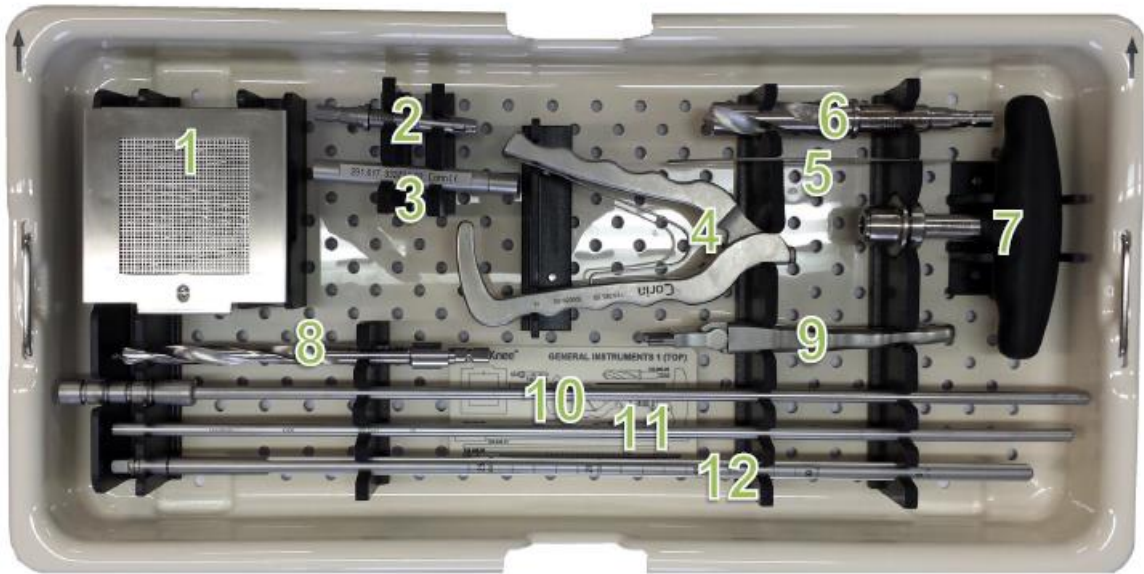

Ref#	Instrument	Codes
	Upper tray	CG000189
1	Driven collarless pin - long	123.346.00
	Driven collared pin - medium	123.347.01
	Driven collared pin - short	123.347.02
	Pin box	291.617
2	Pin driver - hall Zimmer	123.350.00
	Pin driver - AO	A123.350.00
	Pin driver - Hudson	H123.350.00
3	Pin impactor	291.617
4	Pin puller	123.085.00
5	Angel wing	123.074.00
6	Tibial stem drill - hall Zimmer	123.065.00
	Tibial stem drill - AO	A123.065.01
	Tibial stem drill - Hudson	H123.065.00
7	T-handle	123.087.00
8	IM drill - hall Zimmer	123.054.00
	IM drill - AO	A123.054.00
	IM drill - Hudson	H123.054.00
9	Alignment guide	123.044.00
10	Female alignment rod	123.045.01
11	Male alignment guide	123.045.02
12	IM rod	123.53.00

Unity Knee™ General Instruments

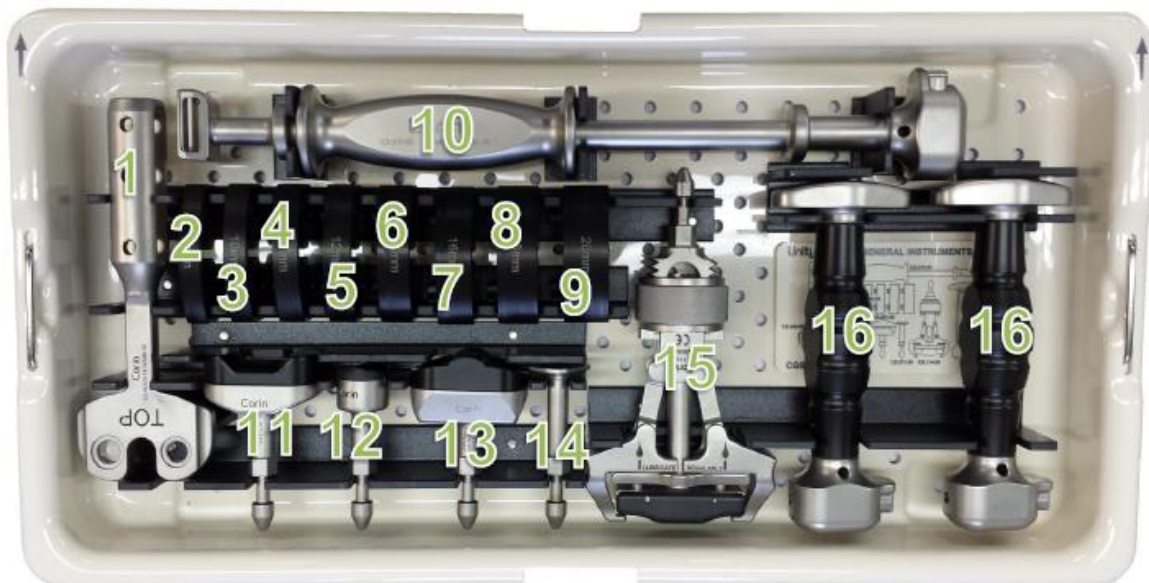

Ref#	Instrument	Codes
	Lower tray	CG000190
1	Gap checker base assembly	123.483.00
2	9mm Gap checker shim assembly	123.483.23
3	10mm Gap checker shim assembly	123.483.24
4	11mm Gap checker shim assembly	123.483.25
5	12mm Gap checker shim assembly	123.483.26
6	14mm Gap checker shim assembly	123.483.27
7	16mm Gap checker shim assembly	123.483.28
8	18mm Gap checker shim assembly	123.483.29
9	20mm Gap checker shim assembly	123.483.30
10	Slap hammer	123.079.00
11	Tibia baseplate impactor	123.072.00
12	Tibia insert impactor	123.077.00
13	Femoral final impactor	123.091.00
14	Femoral trial extraction tool	123.371.00
15	Femoral implant introducer	123.114.00
16	Modular handle	123.052.00

Unity Knee™ CR Femoral Trials



Ref#	Instrument	Codes
	Upper tray	CG000037
1	Monoblock femoral trial CR right size 3	123.368.13
2	Monoblock femoral trial CR right size 4	123.368.14
3	Monoblock femoral trial CR right size 5	123.368.15
4	Monoblock femoral trial CR right size 6	123.368.16
5	Monoblock femoral trial CR right size 7	123.368.17
6	Monoblock femoral trial CR right size 8	123.368.18
	Femoral peg drill - hall Zimmer	123.066.00
7	Femoral peg drill – A/O	A123.066.00
	Femoral peg drill - Hudson	H123.066.00
8	Monoblock femoral trial CR left size 3	123.368.03
9	Monoblock femoral trial CR left size 4	123.368.04
10	Monoblock femoral trial CR left size 5	123.368.05
11	Monoblock femoral trial CR left size 6	123.368.06
12	Monoblock femoral trial CR left size 7	123.368.07
13	Monoblock femoral trial CR left size 8	123.368.08

Unity Knee™ CR Insert trials (Size 3-8)



Ref# Instrument

Codes

Ref#	Instrument	Codes
	Lower tray	CG000038
1	CR Tibial insert trial size 3 9mm	123.369.13
2	CR Tibial insert trial size 3 10mm	123.369.23
3	CR Tibial insert trial size 3 11mm	123.369.33
4	CR Tibial insert trial size 3 12mm	123.369.43
5	CR Tibial insert trial size 3 14mm	123.369.53
6	CR Tibial insert trial size 3 16mm	123.369.63
7	CR Tibial insert trial size 4 16mm	123.369.64
8	CR Tibial insert trial size 4 14mm	123.369.54
9	CR Tibial insert trial size 4 12mm	123.369.44
10	CR Tibial insert trial size 4 11mm	123.369.34
11	CR Tibial insert trial size 4 10mm	123.369.24
12	CR Tibial insert trial size 4 9mm	123.369.14
13	CR Tibial insert trial size 5 9mm	123.369.15
14	CR Tibial insert trial size 5 10mm	123.369.25
15	CR Tibial insert trial size 5 11mm	123.369.35
16	CR Tibial insert trial size 5 12mm	123.369.45
17	CR Tibial insert trial size 5 14mm	123.369.55

Unity Knee™ CR Insert trials (Size 3-8) (contd.)



Ref#	Instrument	Codes
18	CR Tibial insert trial size 5 16mm	123.369.65
19	CR Tibial insert trial size 6 16mm	123.369.66
20	CR Tibial insert trial size 6 14mm	123.369.56
21	CR Tibial insert trial size 6 12mm	123.369.46
12	CR Tibial insert trial size 6 11mm	123.369.36
23	CR Tibial insert trial size 6 10mm	123.369.26
24	CR Tibial insert trial size 6 9mm	123.369.16
25	CR Tibial insert trial size 7 9mm	123.369.17
26	CR Tibial insert trial size 7 10mm	123.369.27
27	CR Tibial insert trial size 7 11mm	123.369.37
28	CR Tibial insert trial size 7 12mm	123.369.47
29	CR Tibial insert trial size 7 14mm	123.369.57
30	CR Tibial insert trial size 7 16mm	123.369.67
31	CR Tibial insert trial size 8 16mm	123.369.68
32	CR Tibial insert trial size 8 14mm	123.369.58
33	CR Tibial insert trial size 8 12mm	123.369.48
34	CR Tibial insert trial size 8 11mm	123.369.38
35	CR Tibial insert trial size 8 10mm	123.369.28
36	CR Tibial insert trial size 8 9mm	123.369.18

Unity Knee™ Macro Tray



Ref#	Instrument	Codes
	Upper tray	CG000039
1	Tibial template - trial size 9	123.355.09
2	4:1 cutting block size 9	123.531.00
3	Monoblock femoral trial PS right size 9	123.367.19
4	Monoblock femoral trial PS left size 9	123.367.09
5	Monoblock femoral trial CR left size 9	123.368.09
6	Monoblock femoral trial CR right size 9	123.368.19
7	CR tibial insert trial #9 - 9mm	123.369.19
8	CR tibial insert trial #9 - 10mm	123.369.29
9	CR tibial insert trial #9 - 11mm	123.369.39
10	CR tibial insert trial #9 - 12mm	123.369.49
11	CR tibial insert trial #9 - 14mm	123.369.59
12	CR tibial insert trial #9 - 16mm	123.369.69

Unity Knee™ Balancer Tray

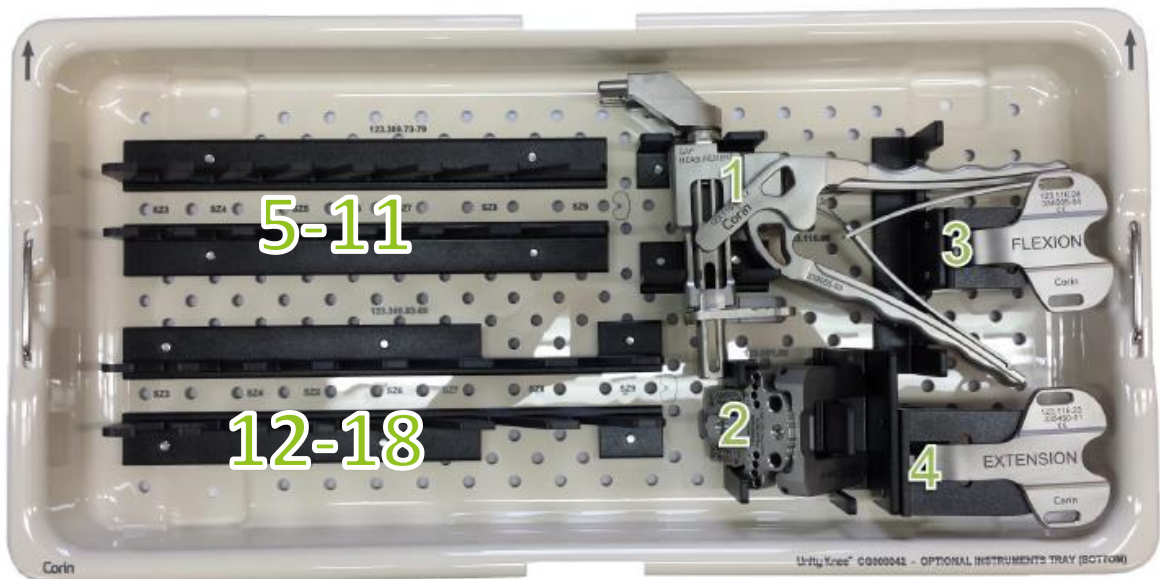

Ref# Instrument

Codes

Ref#	Instrument	Codes
	Lower tray	CG00042
1	Equibalence ligament tensioner	123.116.00
2	Equibalence ligament balancer	123.081.00
3	Tensioner paddle flexion	123.116.24
4	Tensioner paddle extension	123.116.23
5	CR tibial insert trial size 3 18mm	123.369.73
6	CR tibial insert trial size 4 18mm	123.369.74
7	CR tibial insert trial size 5 18mm	123.369.75
8	CR tibial insert trial size 6 18mm	123.369.76
9	CR tibial insert trial size 7 18mm	123.369.77
10	CR tibial insert trial size 8 18mm	123.369.78
11	CR tibial insert trial size 9 18mm	123.369.79
12	CR tibial insert trial size 3 20mm	123.369.83
13	CR tibial insert trial size 4 20mm	123.369.84
14	CR tibial insert trial size 5 20mm	123.369.85
15	CR tibial insert trial size 6 20mm	123.369.86
16	CR tibial insert trial size 7 20mm	123.369.87
17	CR tibial insert trial size 8 20mm	123.369.88
18	CR tibial insert trial size 9 20mm	123.369.89

Unity Knee™ PS Femur Trials



Ref#	Instrument	Codes
	Upper tray	CG00041
1	Monoblock femoral trial PS left size 3	123.367.03
2	Monoblock femoral trial PS left size 4	123.367.04
3	Monoblock femoral trial PS left size 5	123.367.05
4	Monoblock femoral trial PS left size 6	123.367.06
5	Monoblock femoral trial PS left size 7	123.367.07
6	Monoblock femoral trial PS left size 8	123.367.08
7	Monoblock PS box cutting guide 8 to 9	123.342.03
8	Monoblock PS box cutting guide size 3 to 7	123.342.02
9	PS post extraction tool	123.370.90
10	Tibial PS insert post sizes 3 to 9	123.370.20
11	Monoblock femoral trial PS right size 3	123.367.13
12	Monoblock femoral trial PS right size 4	123.367.14
13	Monoblock femoral trial PS right size 5	123.367.15
14	Monoblock femoral trial PS right size 6	123.367.16
15	Monoblock femoral trial PS right size 7	123.367.17
16	Monoblock femoral trial PS right size 8	123.367.18

Unity Knee™ Patella Preparation

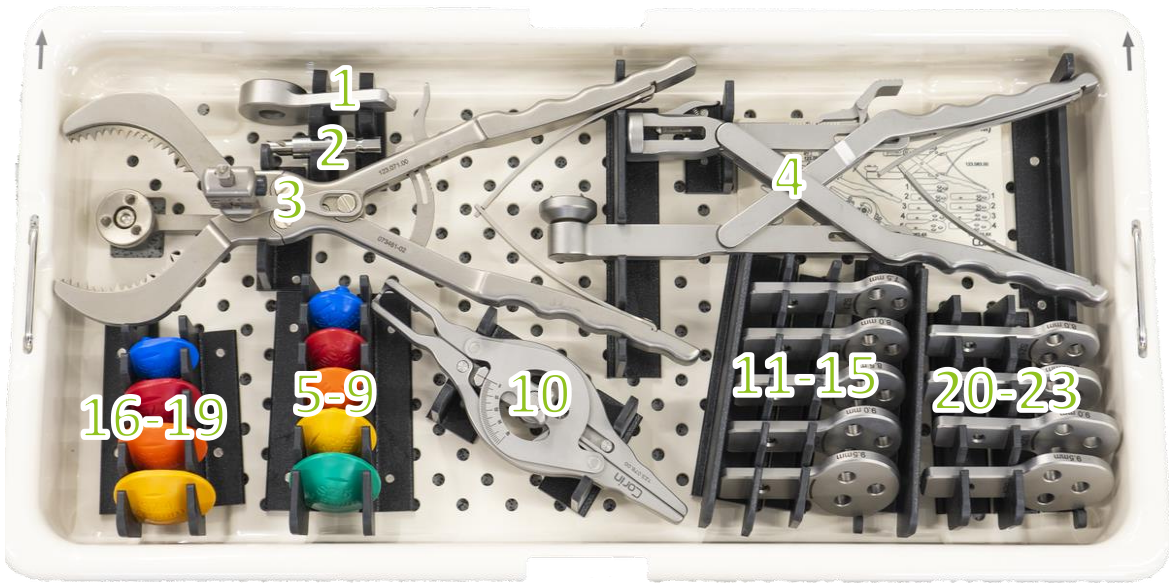

Ref#	Instrument	Codes
	Lower tray	CG000040
1	Patella compression attachment	123.083.30
2	Patella drill - hall Zimmer	123.083.50
	Patella drill - AO	A123.083.50
	Patella drill - Hudson	H123.083.50
3	Patella resection clamp	123.071.00
4	Patella compression plate	123.083.00
5	Dome patella trial size 1	123.075.01
6	Dome patella trial size 2	123.075.02
7	Dome patella trial size 3	123.075.03
8	Dome patella trial size 4	123.075.04
9	Dome patella trial size 5	123.075.05
10	Patella calliper	123.076.00
11	Patella drill guide dome size 1	123.083.41
12	Patella drill guide dome size 2	123.083.42
13	Patella drill guide dome size 3	123.083.43
14	Patella drill guide dome size 4	123.083.44
15	Patella drill guide dome size 5	123.083.45
16	Offset dome patella trial size 1	123.075.11
17	Offset dome patella trial size 2	123.075.12
18	Offset dome patella trial size 3	123.075.13
19	Offset dome patella trial size 4	123.075.14
20	Patella drill guide offset dome size 1	123.083.61
21	Patella drill guide offset dome size 2	123.083.62
22	Patella drill guide offset dome size 3	123.083.63
23	Patella drill guide offset dome size 4	123.083.64

Unity Knee™ CS Tibial Insert Trials (Size 3-9)

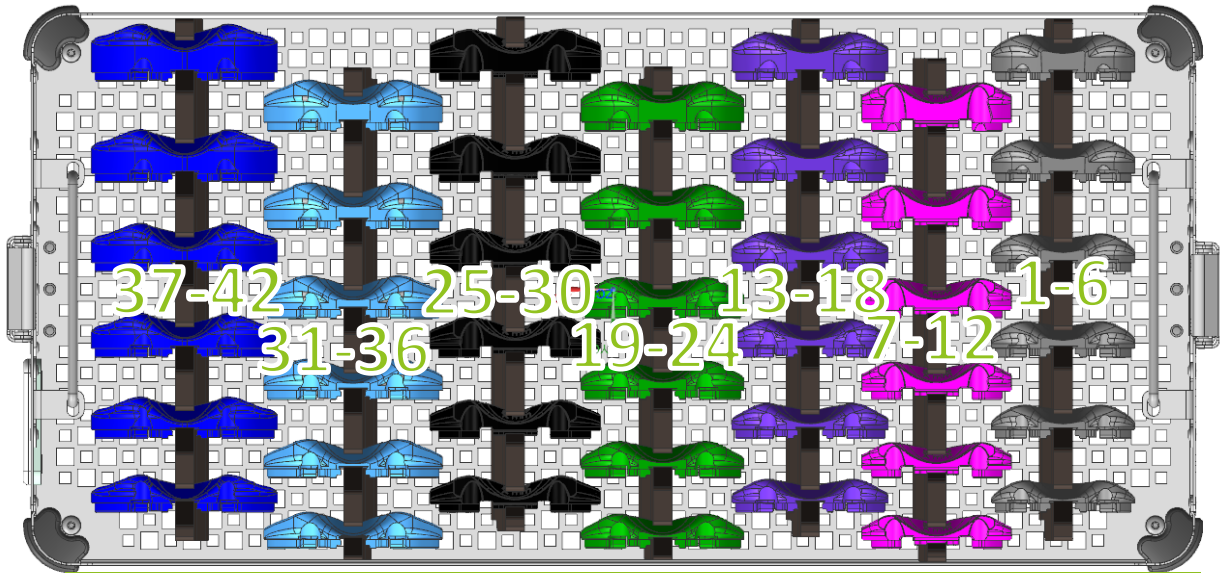

Ref#	Instrument	Codes
	Unity standard set cs tray	1232371
	Instrument tray lid	3999033
1	Unity cs tibial insert trial sz 3 th9	1233030
2	Unity cs tibial insert trial sz 3 th10	1233031
3	Unity cs tibial insert trial sz 3 th11	1233032
4	Unity cs tibial insert trial sz 3 th12	1233033
5	Unity cs tibial insert trial sz 3 th14	1233034
6	Unity cs tibial insert trial sz 3 th16	1233035
7	Unity cs tibial insert trial sz 4 th16	1233045
8	Unity cs tibial insert trial sz 4 th14	1233044
9	Unity cs tibial insert trial sz 4 th12	1233043
10	Unity cs tibial insert trial sz 4 th11	1233042
11	Unity cs tibial insert trial sz 4 th10	1233041
12	Unity cs tibial insert trial sz 4 th9	1233040
13	Unity cs tibial insert trial sz 5 th9	1233050
14	Unity cs tibial insert trial sz 5 th10	1233051
15	Unity cs tibial insert trial sz 5 th11	1233052
16	Unity cs tibial insert trial sz 5 th12	1233053
17	Unity cs tibial insert trial sz 5 th14	1233054
18	Unity cs tibial insert trial sz 5 th16	1233055
19	Unity cs tibial insert trial sz 6 th16	1233065
20	Unity cs tibial insert trial sz 6 th14	1233064
21	Unity cs tibial insert trial sz 6 th12	1233063
22	Unity cs tibial insert trial sz 6 th11	1233062
23	Unity cs tibial insert trial sz 6 th10	1233061
24	Unity cs tibial insert trial sz 6 th9	1233060

Unity Knee™ CS Tibial Insert Trials (Size 3-9) (contd.)

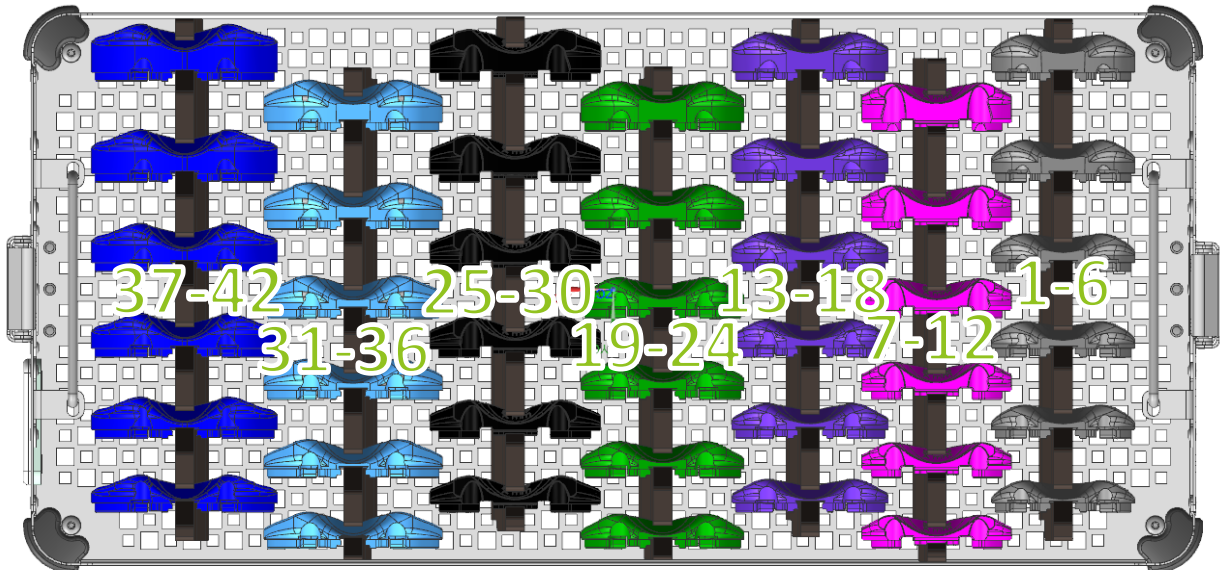

Ref#	Instrument	Codes
25	Unity cs tibial insert trial sz 7 th9	1233070
26	Unity cs tibial insert trial sz 7 th10	1233071
27	Unity cs tibial insert trial sz 7 th11	1233072
28	Unity cs tibial insert trial sz 7 th12	1233073
29	Unity cs tibial insert trial sz 7 th14	1233074
30	Unity cs tibial insert trial sz 7 th16	1233075
31	Unity cs tibial insert trial sz 8 th16	1233085
32	Unity cs tibial insert trial sz 8 th14	1233084
33	Unity cs tibial insert trial sz 8 th12	1233083
34	Unity cs tibial insert trial sz 8 th11	1233082
35	Unity cs tibial insert trial sz 8 th10	1233081
36	Unity cs tibial insert trial sz 8 th9	1233080
37	Unity cs tibial insert trial sz 9 th9	1233090
38	Unity cs tibial insert trial sz 9 th10	1233091
39	Unity cs tibial insert trial sz 9 th11	1233092
40	Unity cs tibial insert trial sz 9 th12	1233093
41	Unity cs tibial insert trial sz 9 th14	1233094
42	Unity cs tibial insert trial sz 9 th16	1233095

Unity Knee™ Stem Preparation

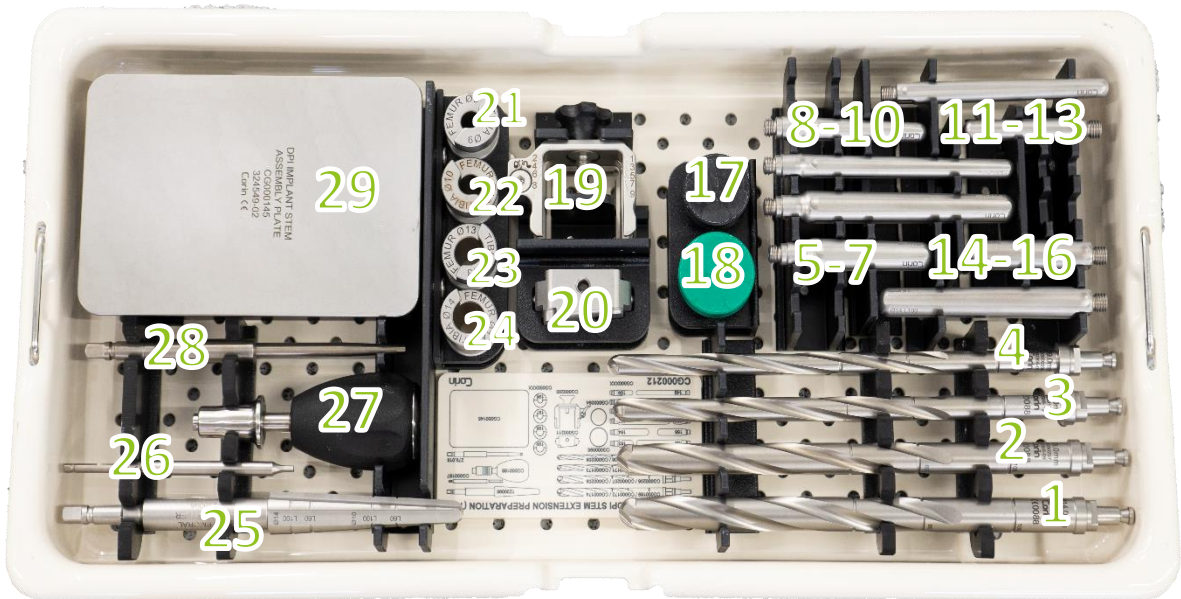

Ref#	Instrument	Codes
	Upper tray	CG000212
1	DPI drill ø14.0mm	CG000169
	DPI A/O drill ø14.0mm	CG000172
	DPI Hudson drill ø14.0mm	CG000174
2	DPI drill ø13.0mm	CG000205
	DPI Hudson drill ø13.0mm	CG000207
	DPI A/O drill ø13.0mm	CG000209
3	DPI drill ø10.0mm	CG000168
	DPI A/O drill ø10.0mm	CG000171
	DPI Hudson drill ø10.0mm	CG000173
4	DPI drill ø9.0mm	CG000204
	DPI Hudson drill ø9.0mm	CG000206
	DPI A/O drill ø9.0mm	CG000208
5	Tibial trial stem extension ø14 length 30mm	CG000154
6	Tibial trial stem extension ø14 length 60mm	CG000155
7	Tibial trial stem extension ø14 length 100mm	CG000156
8	Tibial trial stem extension ø10 length 30mm	CG000147
9	Tibial trial stem extension ø10 length 60mm	CG000148
10	Tibial trial stem extension ø10 length 100mm	CG000149
11	Femoral trial stem extension ø14 length 30mm	CG000163
12	Femoral trial stem extension ø14 length 60mm	CG000164
13	Femoral trial stem extension ø14 length 100mm	CG000165
14	Femoral trial stem extension ø10 length 30mm	CG000159
15	Femoral trial stem extension ø10 length 60mm	CG000160

Unity Knee™ Stem Preparation (contd.)

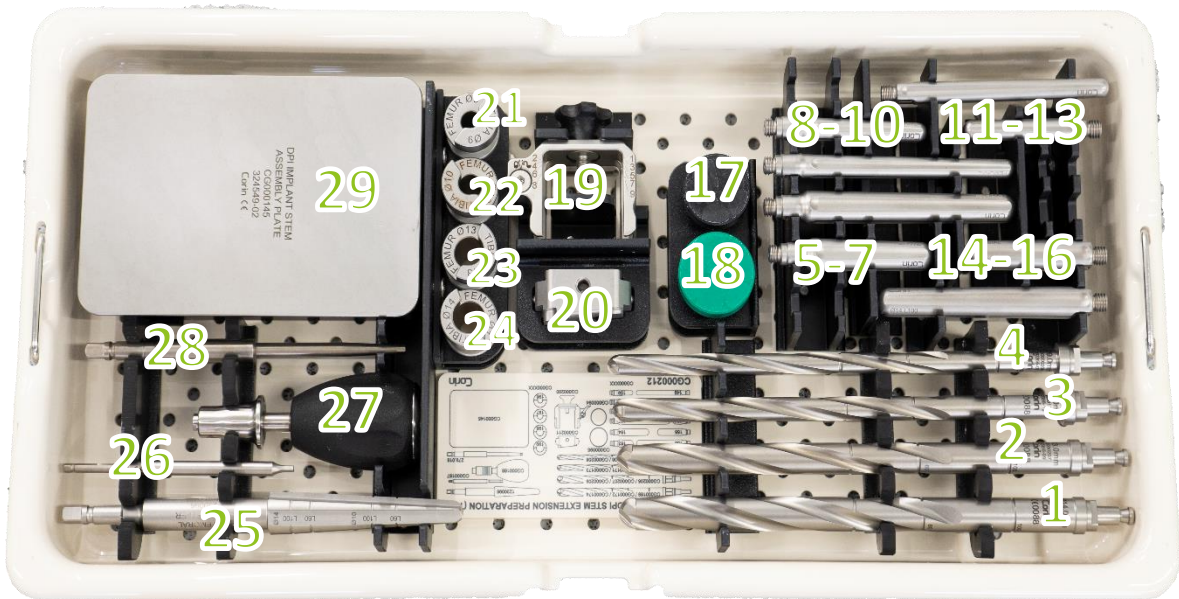

Ref#	Instrument	Codes
16	Femoral trial stem extension ø10 length 100mm	CG000161
17	Stem impaction cap ø10.0	CG000094
18	Stem impaction cap ø14.0	CG000095
19	DPI femoral drill guide assembly	CG000200
20	DPI femoral drill guide bushing assembly	CG000211
21	DPI drill guide ø09	CG000196
22	DPI drill guide ø10	CG000197
23	DPI drill guide ø13	CG000198
24	DPI drill guide ø14	CG000199
25	Femoral stem reamer	1230096
26	DPI hex attachment 2.5mm	CG000167
27	DPI torque handle 2.0 nm	CG000166
28	Hex screwdriver 3.5 A/F	279.018
29	DPI implant stem assembly plate	CG000145

Unity Knee™ Augment Preparation

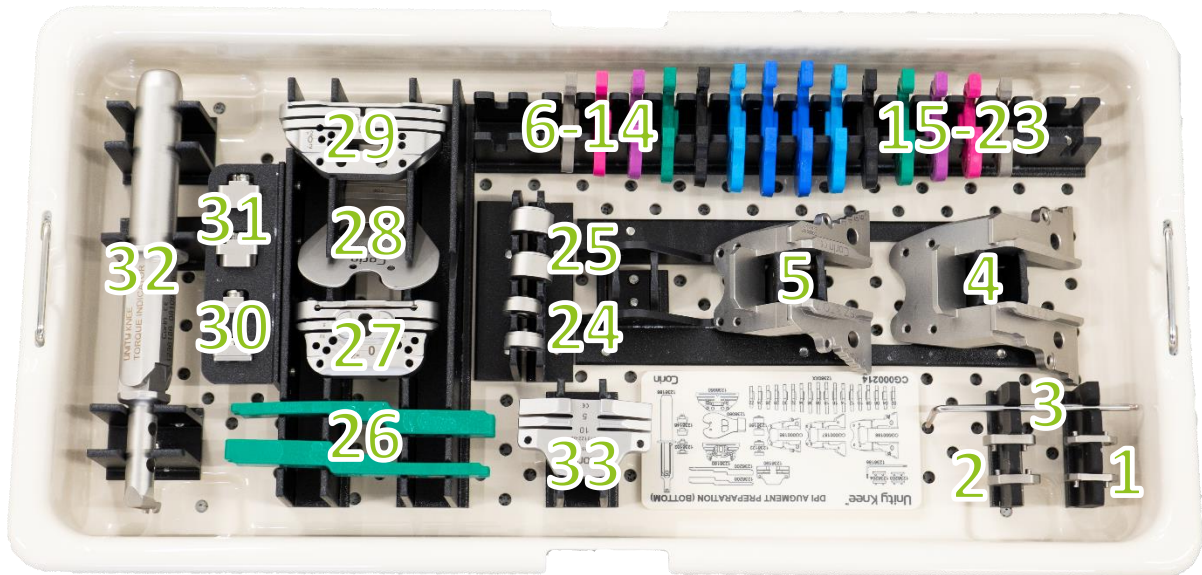

Ref#	Instrument	Codes
	Lower tray	CG00013
1	3mm spacer shims	1236203
2	4mm spacer shims	1236204
3	2.5mm Allen key	1236185
4	Ps box saw resection guide size 8&9	CG000188
5	Ps box saw resection guide size 3-7	CG000187
6	Ps box saw resection guide size 1-2	CG000186
7	Tibial augment trial 5mm RM-LL size 1	1236002
8	Tibial augment trial 5mm RM-LL size 2	1236004
9	Tibial augment trial 5mm RM-LL size 3	1236006
10	Tibial augment trial 5mm RM-LL size 4	1236008
11	Tibial augment trial 5mm RM-LL size 5	1236010
12	Tibial augment trial 5mm RM-LL size 6	1236012
13	Tibial augment trial 5mm RM-LL size 7	1236014
14	Tibial augment trial 5mm RM-LL size 8	1236016
15	Tibial augment trial 5mm RM-LL size 9	1236018
16	Tibial augment trial 5mm LM-RL size 1	1236022

Unity Knee™ Augment Preparation (contd.)

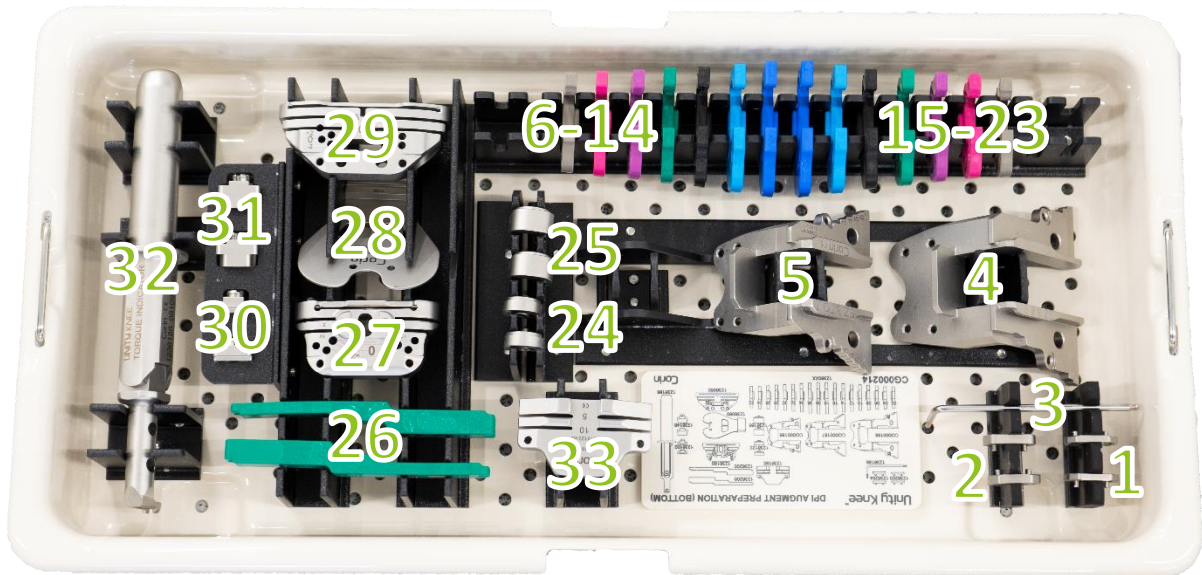

Ref#	Instrument	Codes
17	Tibial augment trial 5mm LM-RL size 2	1236024
18	Tibial augment trial 5mm LM-RL size 3	1236026
19	Tibial augment trial 5mm LM-RL size 4	1236028
20	Tibial augment trial 5mm LM-RL size 5	1236030
21	Tibial augment trial 5mm LM-RL size 6	1236032
22	Tibial augment trial 5mm LM-RL size 7	1236034
23	Tibial augment trial 5mm LM-RL size 8	1236036
24	Tibial augment trial 5mm LM-RL size 9	1236038
25	Posterior augment trials 5mm	1236122
26	Posterior augment trials 10mm	1236166
27	Universal spacer	1236200
28	Distal augment cutting block	1236180
29	Tibial repositioning guide	1236060
30	Tibial augment cutting guide	1236050
31	Distal augment trials 5mm	1236102
32	Distal augment trials 10mm	1236146
33	Torque indicator	1236186
34	Posterior augment cutting block	1236190

Unity Knee™ ASC Tray 1

Tibial and Femoral prep

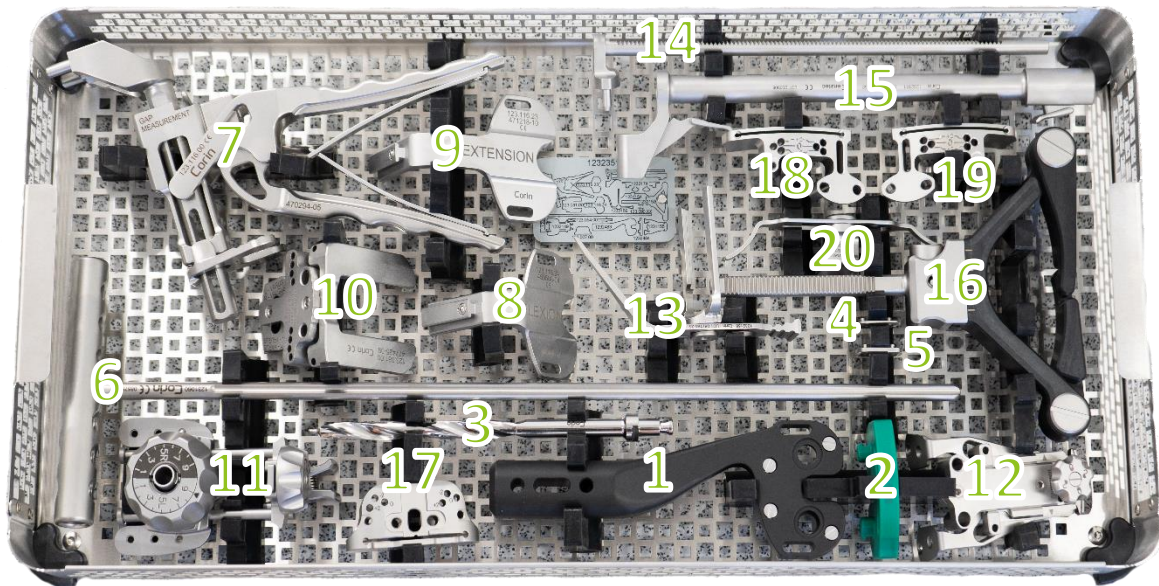

Ref#	Instrument	Codes
	Tray 1*	1232351
1	Gap checker base assembly	1232483
2	Gap checker shim assembly	1232484
	Hudson - IM drill	H123.054.00
3	A/O - IM drill	A123.054.00
	Zimmer Hall - IM drill	123.054.00
4	Femoral sizer shims 1 mm	123.090.01
5	Femoral sizer shims 2 mm	123.090.02
6	Unity ASC intermedullary rod	1231060
7	Ligament tensioner	123.116.00
8	Tibial paddles flexion	123.116.24
9	Tibial paddles extension	123.116.23
10	Extension balancer	123.081.00
11	Distal resection guide	1236010
12	Femoral sizer	1236012
13	Femoral sizer stylus**	1236014
14	EM tibial jig - uprod	1236016
15	EM tibial jig - downrod	1236018
16	Ankle clamp	1236022
17	Distal cutting block	1236024
18	Tibia resection block - left	1236026
19	Tibia resection block - right	1236028
20	Tibial stylus	1236030

* The tray and lid ordering information for standalone configuration is 1232357 and 3999033, respectively.

**Alternative part number 1231156 may be present in the set

Unity Knee™ ASC Tray 2

Patella prep and general

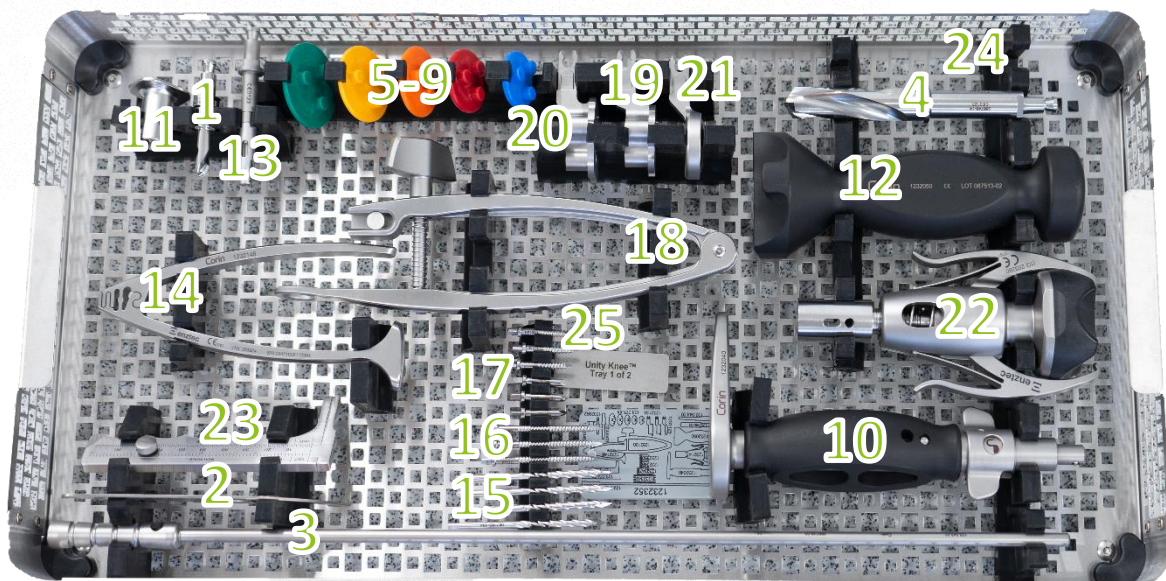

Ref#	Instrument	Codes
	Tray 2*	1232352
	Peg drill Hudson	1232662
1	Peg drill A/O	1232661
	Peg drill Zimmer Hall	1232660
2	Angel wing	123.074.00
3	Female alignment rod	123.045.01
	Hudson – tibial stem drill**	H123.065.00
4	A/O – tibial stem drill**	A123.065.00
	Zimmer Hall – tibial stem drill**	123.065.00
5	Size 1 - 3 peg	123.075.01
6	Size 2 - 3 peg	123.075.02
7	Size 3 – 3 peg	123.075.03
8	Size 4 - 3 peg	123.075.04
9	Size 5 - 3 peg	123.075.05
10	Modular handle	1232040
11	Extraction tool	1232045
12	Universal impactor	1232050
	Pin driver - Hudson	1233502
13	Pin driver - A/O	1233503
	Pin driver - Zimmer Hall	1233501
14	Pin puller	1232146
15	Driven collarless pin - 75mm	1232349
16	Threaded collarled pin long	1232347
17	Short driven collared pin - smooth	1232348
18	Patella Clamp	1232120
19	Centered dome patella_1	1232131
20	Centered dome patella_2	1232133
21	Patella drill guide - compression attachment	1231125
22	Femoral introducer	1232147
23	Townley bone/patella caliper	1231250
24	Alignment guide	123.044.00
25	25mm driven collared pin - threaded	1232350

* The tray and lid ordering information for standalone configuration is 1232358 and 3999033, respectively.

**The stem drill may be present in tray 3

Unity Knee™ ASC Tray 3

Final Tibial and Femoral Prep

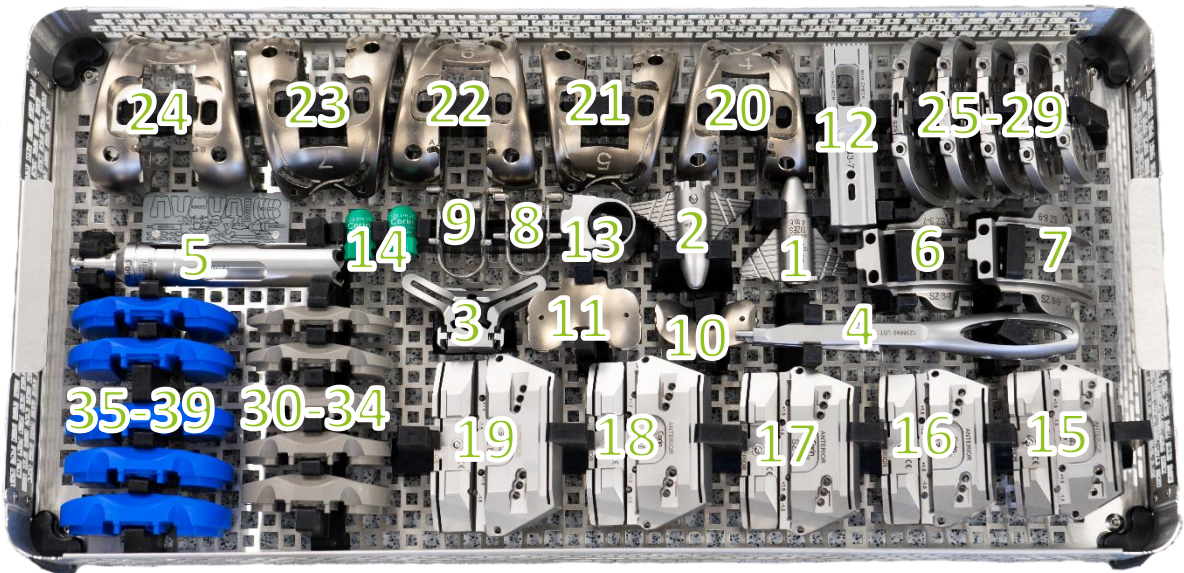

Ref#	Instrument	Codes
	Tray 3*	1232353
1	Tibial keel punch size 4to6	123.061.20
2	Tibial keel punch size 7to9	123.061.30
3	Keel punch guide**	1233574
4	Tibial template handle assembly***	1236640
5	Unity ASC Hole Saw	1232036*
6	Resection guide std	1232031
7	Resection guide macro	1232032
8	Unity ASC PS insert std	1231011000
9	Unity ASC PS insert macro	1231012000
10	Unity ASC CR Insert STD	1232021
11	Unity ASC CR Insert macro	1232022
12	Unity ASC PS Box Chisel	1232035
13	Unity ASC Hole Saw Guide	1232038
14	Tibial PS insert post sizes 3 to 9	123.370.20
15	4:1 Cutting block size 4	123.526.00
16	4:1 Cutting block size 5	123.527.00
17	4:1 Cutting block size 6	123.528.00
18	4:1 Cutting block size 7	123.529.00
19	4:1 Cutting block size 8	123.530.00
20	Femoral trial body Size 4	1232004

* The tray and lid ordering information for standalone configuration is 1232359 and 3999033, respectively.

**Alternative part number 123.357.00 may be present in the set

***Alternative part number 123.364.00 may be present in the set

Unity Knee™ ASC Tray 3 (contd.)

Final Tibial and Femoral Prep

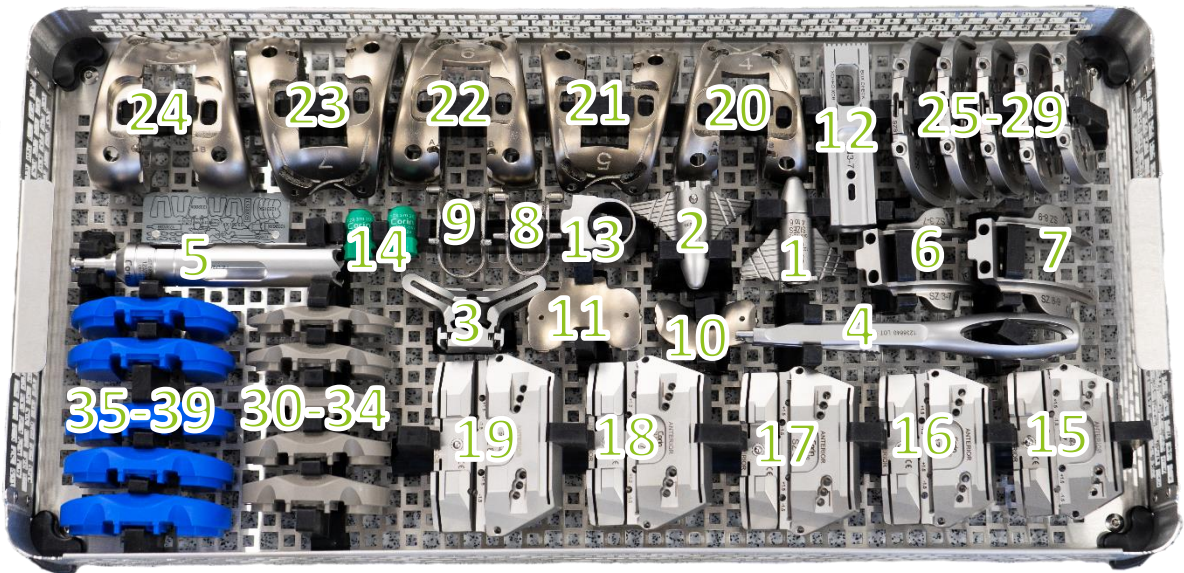

Ref#	Instrument	Codes
21	Femoral trial body Size 5	1232005
22	Femoral trial body Size 6	1232006
23	Femoral trial body Size 7	1232007
24	Femoral trial body Size 8	1232008
25	Tibial tray template Size 4*	1233154
26	Tibial tray template Size 5*	1233155
27	Tibial tray template Size 6*	1233156
28	Tibial tray template Size 7*	1233157
29	Tibial tray template Size 8*	1233158
30	CR insert trial STD Size 4to6 thickness 9mm	1232085
31	CR insert trial STD Size 4to6 thickness 10mm	1232086
32	CR insert trial STD Size 4to6 thickness 11mm	1232087
33	CR insert trial STD Size 4to6 thickness 12mm	1232088
34	CR insert trial STD Size 4to6 thickness 14mm	1232089
35	CR insert trial Macro Size 7to9 thickness 9mm	1232095
36	CR insert trial Macro Size 7to9 thickness 10mm	1232096
37	CR insert trial Macro Size 7to9 thickness 11mm	1232097
38	CR insert trial Macro Size 7to9 thickness 12mm	1232098
39	CR insert trial Macro Size 7to9 thickness 14mm	1232099

*Alternative part number 1232052-9 may be present in the set

Unity Knee™ ASC Tray 4

Outlier sizes

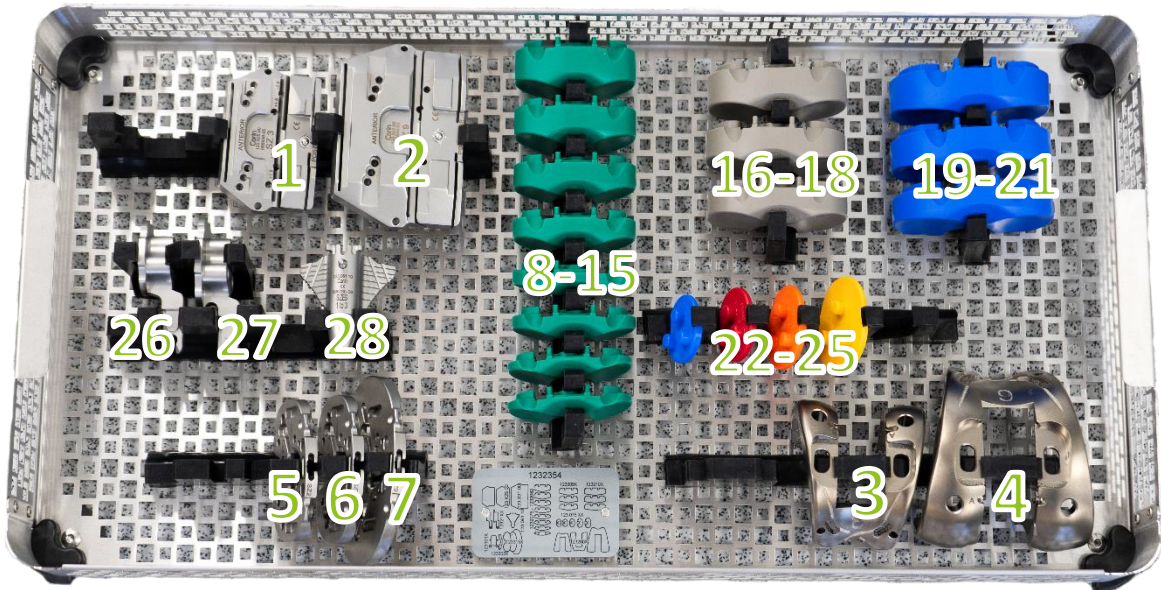

Ref#	Instrument	Codes
	Tray 4*	1232354
1	4:1 Cutting block size 3	123.525.00
2	4:1 Cutting block size 9	123.531.00
3	Femoral trial main body size 3	1232003
4	Femoral trial main body size 9	1232009
5	Tibial tray template trial size 2	1233152
6	Tibial tray template trial size 3	1233153
7	Tibial tray template trial size 9	1233159
8	CR insert trial Size 1to3 thickness 9mm	1232075
9	CR insert trial Size 1to3 thickness 10mm	1232076
10	CR insert trial Size 1to3 thickness 11mm	1232077
11	CR insert trial Size 1to3 thickness 12mm	1232078
12	CR insert trial Size 1to3 thickness 14mm	1232079
13	CR insert trial Size 1to3 thickness 16mm	1232080
14	CR insert trial Size 1to3 thickness 18mm	1232081
15	CR insert trial Size 1to3 thickness 20mm	1232082
16	CR insert trial Size 4to6 thickness 16mm	1232090

* The tray and lid ordering information for standalone configuration is 1232360 and 3999033, respectively.

Unity Knee™ ASC Tray 4 (contd.)

Outlier sizes

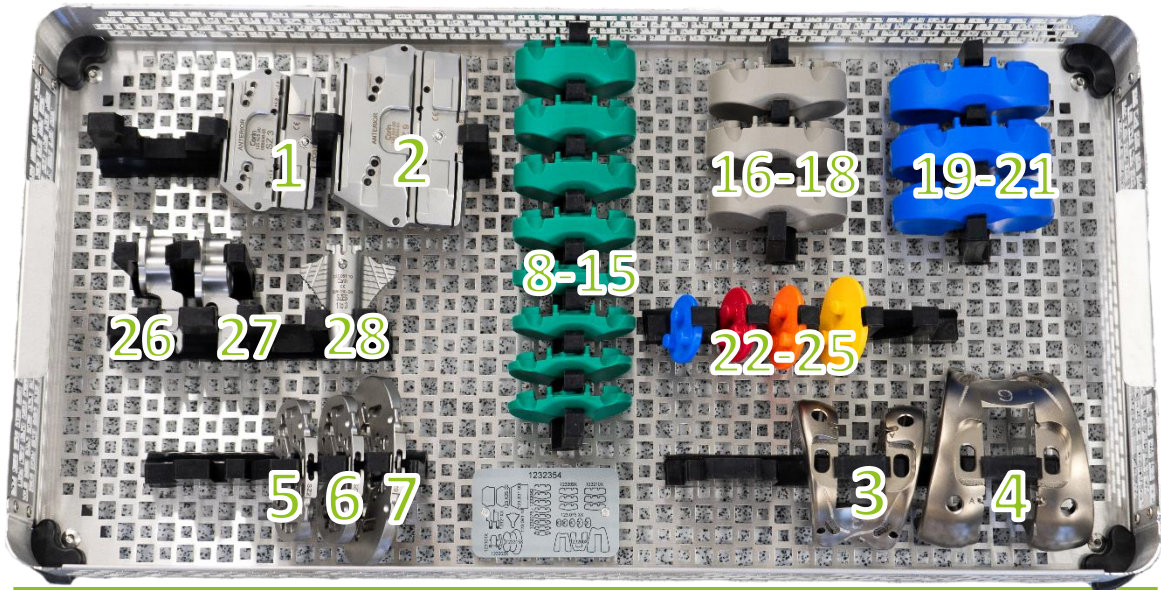

Ref#	Instrument	Codes
17	CR insert trial Size 4to6 thickness 18mm	1232091
18	CR insert trial Size 4to6 thickness 20mm	1232092
19	CR insert trial Size 7to9 thickness 16mm	1232100
20	CR insert trial Size 7to9 thickness 18mm	1232101
21	CR insert trial Size 7to9 thickness 20mm	1232102
22	Offset dome patella trial size 1	123.075.11
23	Offset dome patella trial size 2	123.075.12
24	Offset dome patella trial size 3	123.075.13
25	Offset dome patella trial size 4	123.075.14
26	Patella drill guide - offset patella_1	1232141
27	Patella drill guide - offset patella_2	1232144
28	Tibial keel punch size 1to3	123.061.10
29	Offset dome patella trial size 4	123.075.14
30	Patella drill guide - offset patella_1	1232141
31	Patella drill guide - offset patella_2	1232144
32	Tibial keel punch size 1to3	123.061.10

Unity Knee™ ASC Optional Tray

CS Trials

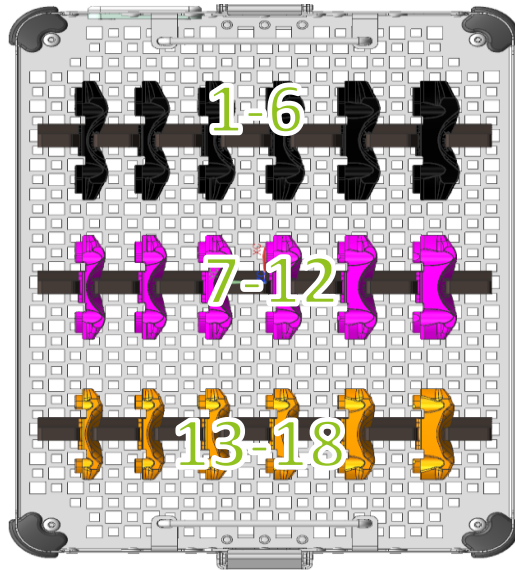

Ref#	Instrument	Codes
	Tray 5	1232372
1	Unity CS trial size 1to3 thickness 9mm	1233010
2	Unity CS trial size 1to3 thickness 10mm	1233011
3	Unity CS trial size 1to3 thickness 11mm	1233012
4	Unity CS trial size 1to3 thickness 12mm	1233013
5	Unity CS trial size 1to3 thickness 14mm	1233014
6	Unity CS trial size 1to3 thickness 16mm	1233015
7	Unity CS trial size 4to6 thickness 9mm	1233040
8	Unity CS trial size 4to6 thickness 10mm	1233041
9	Unity CS trial size 4to6 thickness 11mm	1233042
10	Unity CS trial size 4to6 thickness 12mm	1233043
11	Unity CS trial size 4to6 thickness 14mm	1233044
12	Unity CS trial size 4to6 thickness 16mm	1233045
13	Unity CS trial size 7to9 thickness 9mm	1233070
14	Unity CS trial size 7to9 thickness 10mm	1233071
15	Unity CS trial size 7to9 thickness 11mm	1233072
16	Unity CS trial size 7to9 thickness 12mm	1233073
17	Unity CS trial size 7to9 thickness 14mm	1233074
18	Unity CS trial size 7to9 thickness 16mm	1233075

Unity Knee™ Additional instruments

Ref#	Instrument	Codes
1	IM tibial guide	123.011.00
2	Tibial Introducer	1230124
3	ASC tibial template Size 2	1232052
4	ASC tibial insert sz 1 to 3 - 9mm	1232075
5	ASC tibial insert sz 1 to 3 - 10mm	1232076
6	ASC tibial insert sz 1 to 3 - 11mm	1232077
7	ASC tibial insert sz 1 to 3 - 12mm	1232078
8	ASC tibial insert sz 1 to 3 - 14mm	1232079
9	ASC tibial insert sz 1 to 3 - 16mm	1232080
10	ASC tibial insert sz 1 to 3 - 18mm	1232081
11	ASC tibial insert sz 1 to 3 - 20mm	1232082



Unity Knee™ Ordering Information

	Tray Number	Description
Core	C123.000.01A	PS only core kit
	C123.000.01	Monoblock core instrument set
Alternative	C123.000.02	Alternative set 1 - Hudson fittings
	C123.000.03	Alternative set 2 - AO fittings
	C123.000.04	Alternative set 3 - Zimmer fittings
Optional	C123.000.05	Option set 1 - size 9
	C123.000.06	Option set 2 - ligament balancing
	C123.000.07	Option set 3 - ligament balancing flexion only
	C123.000.08	Option set 4 - thicker inserts
	C123.000.09	Option set 5 - patella both offsets (Hudson)
	C123.000.10	Option set 6 - offset patella (Hudson)
	C123.000.11	Option set 7 - dome patella (Hudson)
	C123.000.12	Option set 8 - patella both offsets (AO)
	C123.000.13	Option set 9 - offset patella (AO)
	C123.000.14	Option set 10 - dome patella (AO)
	C123.000.15	Option set 11 - patella both (Zimmer)
	C123.000.16	Option set 12 - offset patella (Zimmer)
	C123.000.17	Option set 13 - dome patella (Zimmer)
	C123.000.18	Option 14 – CS trials size 3-9

Unity ASC instrument

Tray Number	Description
U123.200.06	Unity ASC instrument set-Aesculap – Hudson
U123.200.08	Unity ASC instrument set- Standalone - Hudson
U123.200.10	Unity ASC instrument set-Aesculap – Zimmer Hall
U123.200.11	Unity ASC instrument set- Standalone - Zimmer Hall
U123.200.12	Unity ASC instrument set-Aesculap – AO
U123.200.13	Unity ASC instrument set- Standalone - AO

Unity DPI instrument

Tray Number	Description
U123.100.05	Stem set with Hudson fitting (.03 for AO fitting)
U123.100.35	Stem and Augment with Hudson fitting (.33 for AO fitting)

Unity Knee™ - Support Materials



Unity Knee™ Measured resection Surgical Technique

- HubSpot → Sales Support Hub → Knee → Unity Knee → Unity Knee MR Surgical Technique I1136



Unity Knee™ Ligament Balancing Surgical Technique

- HubSpot → Sales Support Hub → Knee → Unity Knee → Unity Knee LB Surgical Technique I1300



Unity Knee™ ASC Surgical Technique

- HubSpot → Sales Support Hub → Knee → Unity Knee → Unity Knee ASC Surgical Technique I1521

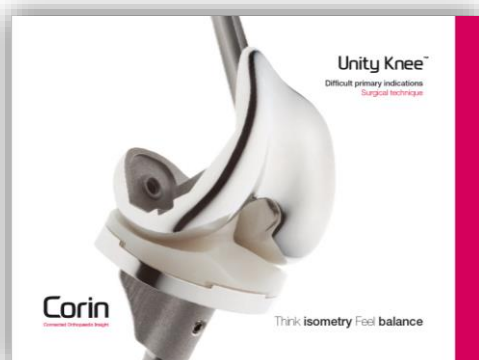

Unity Knee™ DPI Surgical Technique

- HubSpot → Sales Support Hub → Knee → Unity Knee → Unity KNEE DPI Surgical Technique I1348

Unity Knee™ - Support Materials

Unity Knee™ Instrumentation:
Unity Knee™ is a high performance knee solution designed to provide a patient centered total knee replacement solution to the orthopedic surgeon. The instrumentation is designed to be used in a minimally invasive approach. The instrumentation is designed to be used in a minimally invasive approach. The instrumentation is designed to be used in a minimally invasive approach.

3 Key selling points for Unity Knee™
1. **Advanced design:** The Unity Knee™ is designed to provide a patient centered total knee replacement solution. The instrumentation is designed to be used in a minimally invasive approach. The instrumentation is designed to be used in a minimally invasive approach.

2. Minimal surgery: The Unity Knee™ is designed to provide a patient centered total knee replacement solution. The instrumentation is designed to be used in a minimally invasive approach. The instrumentation is designed to be used in a minimally invasive approach.

3. Evidence based design: The Unity Knee™ is designed to provide a patient centered total knee replacement solution. The instrumentation is designed to be used in a minimally invasive approach. The instrumentation is designed to be used in a minimally invasive approach.

Who are the global KOC, developer engineers?
Prof. Armin Bueckner, Dr. Stefan Hoyer, Dr. Thomas Hoyer, Prof. Dr. Armin Bueckner, Dr. Stefan Hoyer, Dr. Thomas Hoyer.

Unity Knee™ **Frequently asked questions**
For internal use only

Unity Knee™ Frequently Asked Questions

- HubSpot → Sales Support Hub → Knee → Unity Knee → Unity Knee FAQ I1391

What does ASC mean?
Unity ASC is an advanced design and cost effective instrument set suitable for all customers.

What procedures are covered?
The Unity ASC instrument set is designed for use in a minimally invasive approach. The instrumentation is designed to be used in a minimally invasive approach. The instrumentation is designed to be used in a minimally invasive approach.

How do I manage a new CB design?
The Unity ASC instrument set is designed for use in a minimally invasive approach. The instrumentation is designed to be used in a minimally invasive approach. The instrumentation is designed to be used in a minimally invasive approach.

Is Unity ASC compatible with Unity DPI?
Yes, the Unity ASC instrument set is designed for use in a minimally invasive approach. The instrumentation is designed to be used in a minimally invasive approach. The instrumentation is designed to be used in a minimally invasive approach.

Why does the spacer block only include a Shim Shim?
The Shim Shim is designed to provide a patient centered total knee replacement solution. The instrumentation is designed to be used in a minimally invasive approach. The instrumentation is designed to be used in a minimally invasive approach.

What does the spacer block only include a Shim Shim?
The Shim Shim is designed to provide a patient centered total knee replacement solution. The instrumentation is designed to be used in a minimally invasive approach. The instrumentation is designed to be used in a minimally invasive approach.

Unity Knee™ ASC **Frequently asked questions**
For internal use only

Unity Knee™ ASC Frequently Asked Questions

- HubSpot → Sales Support Hub → Knee → Unity Knee → Unity Knee FAQ I1595

What is Unity DPI?
Unity DPI is a high performance knee solution designed to provide a patient centered total knee replacement solution to the orthopedic surgeon. The instrumentation is designed to be used in a minimally invasive approach. The instrumentation is designed to be used in a minimally invasive approach.

What are the main features of Unity DPI?
The Unity DPI is designed to provide a patient centered total knee replacement solution. The instrumentation is designed to be used in a minimally invasive approach. The instrumentation is designed to be used in a minimally invasive approach.

What are the main features of Unity DPI?
The Unity DPI is designed to provide a patient centered total knee replacement solution. The instrumentation is designed to be used in a minimally invasive approach. The instrumentation is designed to be used in a minimally invasive approach.

How can a surgeon implant a Shim without a DPI instrument set?
The Shim Shim is designed to provide a patient centered total knee replacement solution. The instrumentation is designed to be used in a minimally invasive approach. The instrumentation is designed to be used in a minimally invasive approach.

Unity Knee™ DPI **Frequently asked questions**
For internal use only

Unity Knee™ DPI Frequently Asked Questions

- HubSpot → Sales Support Hub → Knee → Unity Knee → Unity Knee FAQ I1594



Unity Knee™ Evidence Base

- HubSpot → Sales Support Hub → Knee → Unity Knee → Unity Knee Evidence Base I1274

Unity Knee™ - Support Materials



Unity Knee™ 2p flyer

- HubSpot → Sales Support Hub → Knee → Unity Knee → Unity Knee 2p flyer I1551



Unity Knee™ ASC 2p flyer

- HubSpot → Sales Support Hub → Knee → Unity Knee → Unity Knee 2p flyer I1585



Unity Knee™ DPI 2p flyer

- HubSpot → Sales Support Hub → Knee → Unity Knee → Unity Knee 2p flyer I1552

Competitor	Unity Knee	Unity Knee	Unity Knee	Unity Knee	Unity Knee	Unity Knee	Unity Knee	Unity Knee	Unity Knee	Unity Knee	Unity Knee	Unity Knee	Unity Knee	Unity Knee	Unity Knee	Unity Knee	Unity Knee	Unity Knee
Corin	Yes	Yes	Yes	Yes	Yes	Yes	Yes	Yes	Yes	Yes	Yes	Yes	Yes	Yes	Yes	Yes	Yes	Yes
Smith & Nephew	Yes	Yes	Yes	Yes	Yes	Yes	Yes	Yes	Yes	Yes	Yes	Yes	Yes	Yes	Yes	Yes	Yes	Yes
DePuy	Yes	Yes	Yes	Yes	Yes	Yes	Yes	Yes	Yes	Yes	Yes	Yes	Yes	Yes	Yes	Yes	Yes	Yes
...

Competitor summary
For internal use only

Unity Knee™ competitor summary

- HubSpot → Sales Support Hub → Knee → Unity Knee → Unity Knee Competitor Profiles

Unity Knee™ - Support Materials

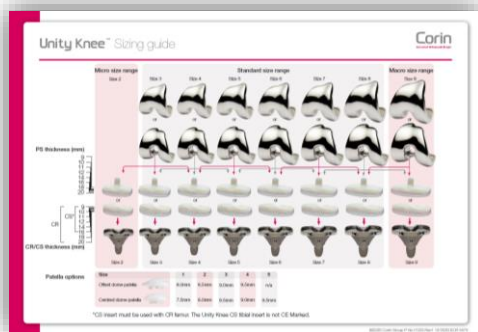

Unity Knee™ compatibility chart

- HubSpot → Sales Support Hub → Knee → Unity Knee → Unity Knee compatibility chart I1223

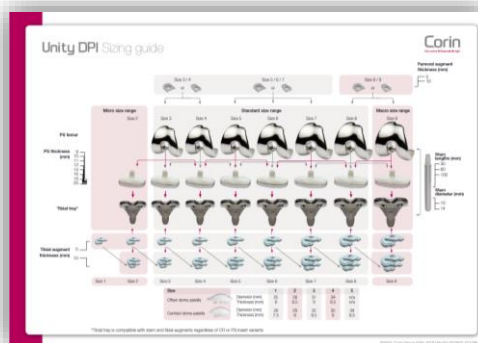

Unity Knee™ DPI compatibility chart

- HubSpot → Sales Support Hub → Knee → Unity Knee → Unity Knee DPI compatibility chart I610

Unity Knee™ Instrument tray layouts

Table and Femoral Preparation

Qty	Product description	Qty	Product description	Qty
1	15039401 1/2 Bore femoral tray	1	15039401 1/2 Bore femoral tray	1
1	15039402 1/2 Bore femoral tray	1	15039402 1/2 Bore femoral tray	1
1	15039403 1/2 Bore femoral tray	1	15039403 1/2 Bore femoral tray	1
1	15039404 1/2 Bore femoral tray	1	15039404 1/2 Bore femoral tray	1
1	15039405 1/2 Bore femoral tray	1	15039405 1/2 Bore femoral tray	1
1	15039406 1/2 Bore femoral tray	1	15039406 1/2 Bore femoral tray	1
1	15039407 1/2 Bore femoral tray	1	15039407 1/2 Bore femoral tray	1
1	15039408 1/2 Bore femoral tray	1	15039408 1/2 Bore femoral tray	1
1	15039409 1/2 Bore femoral tray	1	15039409 1/2 Bore femoral tray	1
1	15039410 1/2 Bore femoral tray	1	15039410 1/2 Bore femoral tray	1

Unity Knee™ Tray layout

- HubSpot → Sales Support Hub → Knee → Unity Knee → Unity Knee Tray Layout I1325

Unity Knee™ ASC Tray Layout

ASC Platform

N°	Code	Product description	Qty	N°	Product description	Qty
1	15039401	1/2 Bore femoral tray	1	15039401	1/2 Bore femoral tray	1
2	15039402	1/2 Bore femoral tray	1	15039402	1/2 Bore femoral tray	1
3	15039403	1/2 Bore femoral tray	1	15039403	1/2 Bore femoral tray	1
4	15039404	1/2 Bore femoral tray	1	15039404	1/2 Bore femoral tray	1
5	15039405	1/2 Bore femoral tray	1	15039405	1/2 Bore femoral tray	1
6	15039406	1/2 Bore femoral tray	1	15039406	1/2 Bore femoral tray	1
7	15039407	1/2 Bore femoral tray	1	15039407	1/2 Bore femoral tray	1
8	15039408	1/2 Bore femoral tray	1	15039408	1/2 Bore femoral tray	1
9	15039409	1/2 Bore femoral tray	1	15039409	1/2 Bore femoral tray	1
10	15039410	1/2 Bore femoral tray	1	15039410	1/2 Bore femoral tray	1

Unity Knee™ ASC Tray layout

- HubSpot → Sales Support Hub → Knee → Unity Knee → Unity Knee ASC Tray Layout I1524

Unity Knee™ - Support Materials



Unity Knee™ Master Presentation

- HubSpot → Orthopaedic Essentials 2 → Knee → Level 2 → TKA Unity → L2 Unity 1 Master Presentation.pptx/zip



Unity DPI Master Presentation

- HubSpot → Orthopaedic Essentials 2 → Knee → Level 2 → TKA Unity → Unity Knee DPI Master Presentation.pptx/zip

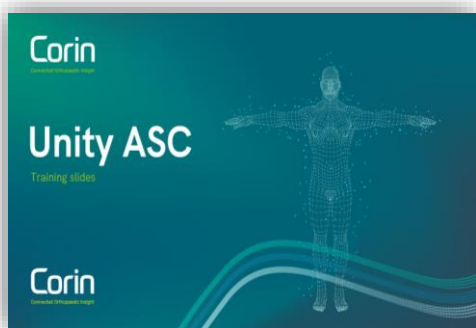

Unity ASC Master Presentation

- HubSpot → Orthopaedic Essentials 2 → Knee → Level 2 → TKA Unity → Unity Knee ASC Master Presentation.pptx/zip



Unity Knee Sales presentation 5 slider

- HubSpot → Sales Support Hub → Knee → Unity Knee → Unity Knee Sales presentation 5 slider